

11" Pull Out App Option Divider App

- Materials and finish to be Spec'd Separately
- ⚠ 11NOV11-Vertical Divider and Demi-shelf width changed to 9 15/16"
- ⚠ 11NOV11-6pc. 2" shelf pins added
- ⚠ 11NOV11-Drilled Holes Replaced with Slots

Material: Birch plywood and Birch/maple solids
 Finish: 3 coat clear top coat finish
 Polished chrome rails and door mounting hardware
 Edgebanded sled assembly
 King 3M52 Soft Close slides

STATUS
05
11" Pull Out App Option Divider App
546.31.800

RevNo	Project # or change Request #	Date	Signature	Checked
001	File updated	12.01.2011	NPG	RM

NOTICE
 THIS DRAWING AND ALL INFORMATION THEREON IS THE PROPERTY OF:

HÄFELE

THIS DRAWING AND INFORMATION THEREON IS CONFIDENTIAL. MUST NOT BE MADE PUBLIC, COPIED OR USED TO DISADVANTAGE OF SAID HÄFELE AMERICA CO. IT IS SUBJECT TO RETURN ON DEMAND.
 2008 HAFELE AMERICA, CO.

DATE:	SPECIFICATION
10.14.2011	
SCALE:	MAT'L: See notes
DRAWN BY: NPG	FINISH: See notes
PUM APPROVAL DT	CUSTOMER APPROVAL

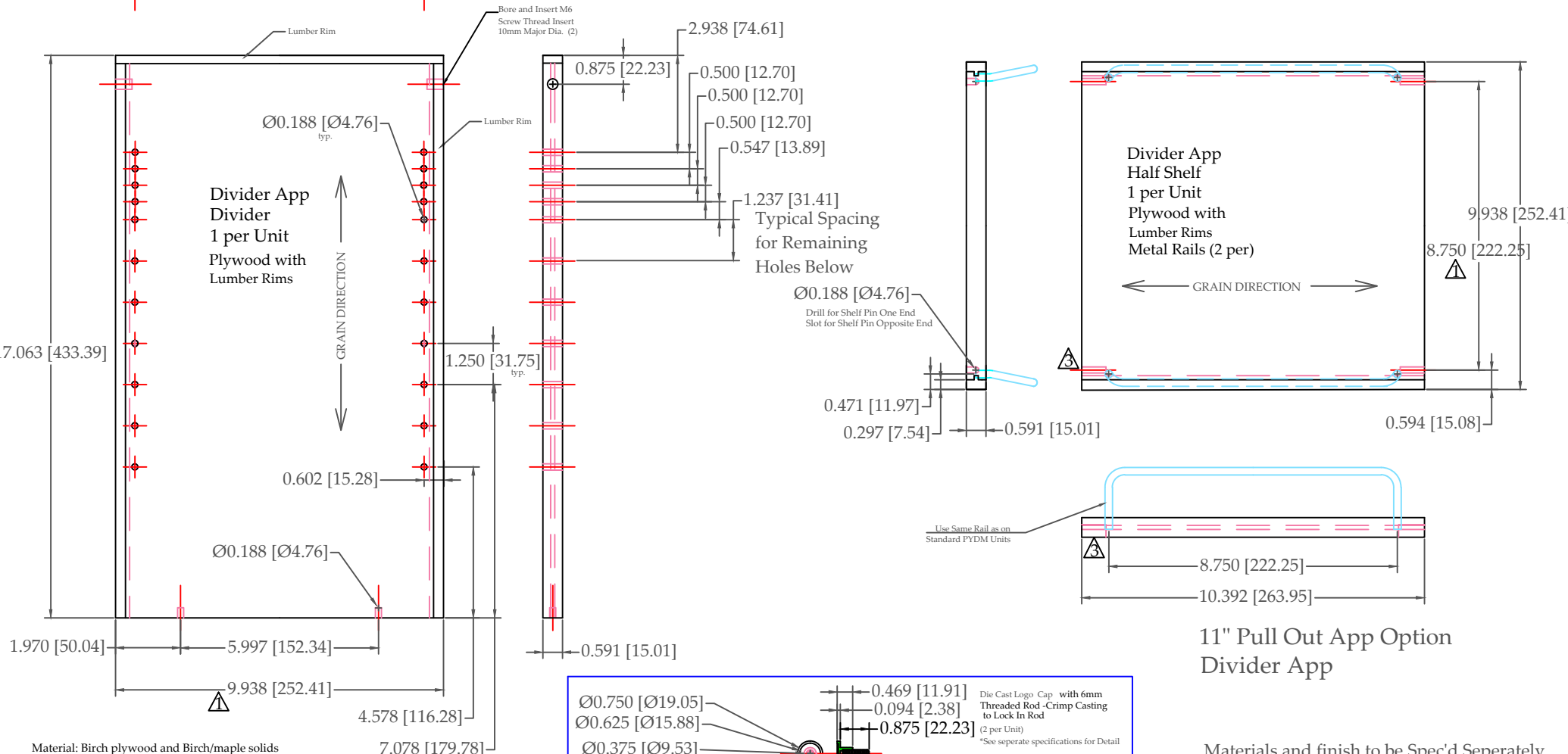

Material: Birch plywood and Birch/maple solids
 Finish: 3 coat clear top coat finish
 Polished chrome rails and door mounting hardware
 Edgebanded sled assembly
 King 3M52 Soft Close slides

Ø0.750 [Ø19.05] — Die Cast Logo Cap with 6mm Threaded Rod - Crimp Casting to Lock In Rod (2 per Unit)
 Ø0.625 [Ø15.88] — *See separate specifications for Detail
 Ø0.375 [Ø9.53] — *Include 6 pc. 2" metal shelf pin-match diameter of std. pins
 2.000 [50.80] —

11" Pull Out App Option Divider App

- Materials and finish to be Spec'd Separately
- △ 11NOV11-Vertical Divider and Demi-shelf width changed to 9 15/16"
- △ 11NOV11-6pc. 2" shelf pins added
- △ 11NOV11-Drilled Holes Replaced with Slots

11" Pull Out App Option

- Materials and finish to be Spec'd Separately
- ▲19OCT11-Pilot Holes for Door Mount Hardware Added
- ▲10NOV11-Drilled Holes Replaced with Slots

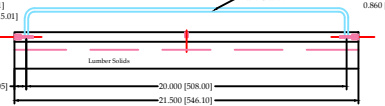
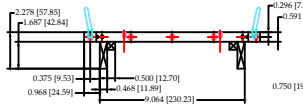
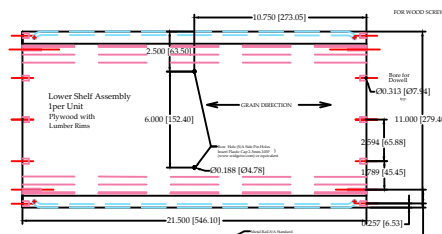
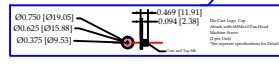
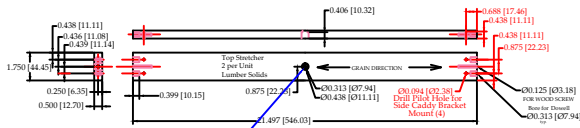
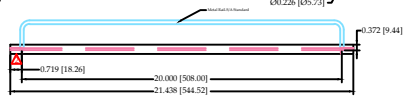
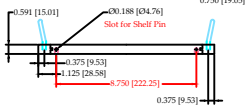
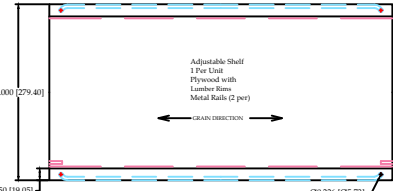
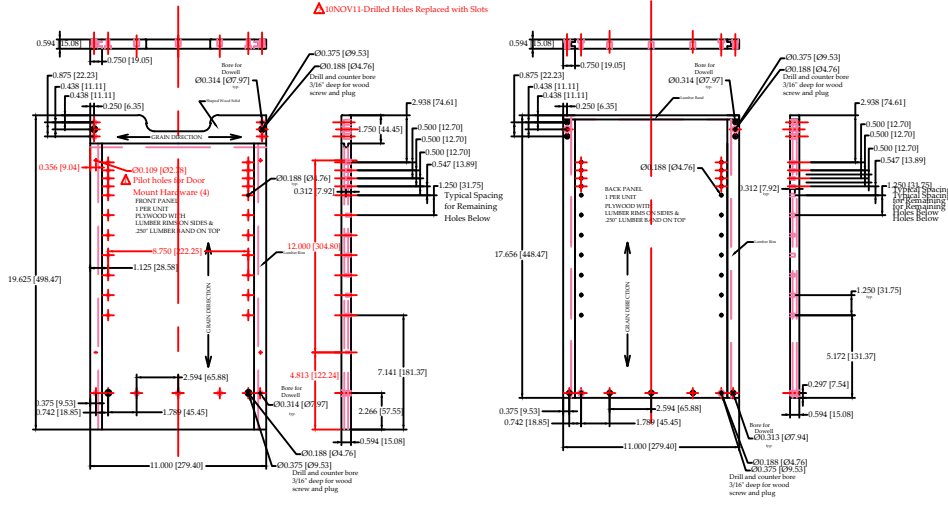

Base Assembly-Note, Same as Standard Pull Out

Material Birch-plywood and Birch-lymph solids
 Finish: 1 coat clear top coat finish
 Distal: 1/8 inch rails and door mounting hardware
 Edgework: 1/8 inch assembly
 King: 1/8 inch door slides

STATUS
05

11in Pullout Unit-Basic Components.REV.001

546.31.800

NOTICE
 THIS DRAWING AND ALL INFORMATION THEREON IS THE PROPERTY OF:



THIS DRAWING AND INFORMATION THEREON IS CONFIDENTIAL. MUST NOT MADE PUBLIC, COPIED OR USED TO DISADVANTAGE OF SAID HAFELE AMERICA CO. IT IS SUBJECT TO RETURN ON DEMAND.

2006 HAFELE AMERICA, CO.

DATE:	10.14.2011
SCALE:	
DRAWN BY:	NPG
PUM APPROVAL	DT

SPECIFICATION
MAT'L: See notes
FINISH: See notes
CUSTOMER APPROVAL

Materials and finish to be Spec'd Separately

- ▲ 19OCT11-Pilot Holes for Door
Mount Hardware Added
- ▲ 10NOV11-Drilled Holes Replaced with Slots

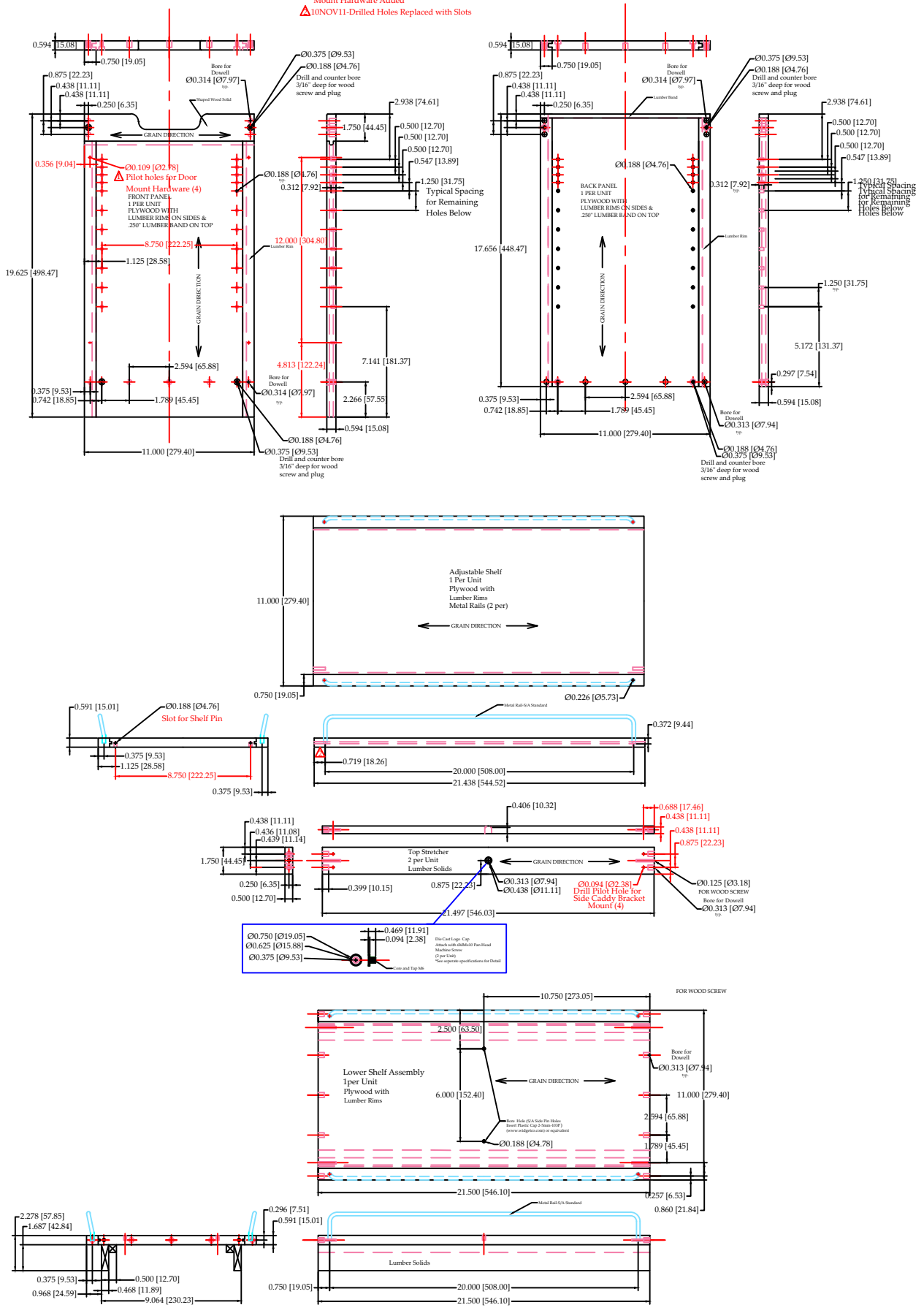

Include 2 Slides
as Separately Specified

Base Assembly: Note, Same as Standard Pull Out

Material: Birch plywood and Birch/maple solids
Finish: 3 coat clear top coat finish
Polished chrome rails and door mounting hardware
Edgeteamed sled assembly
King-MARZ Soft Close slides

Materials and finish to be Spec'd Separately
 ▲ 11NOV11-Divider upright width changed to 9 15/16"
 ▲ 11NOV11-Demi Shelf width changed to 9 15/16"

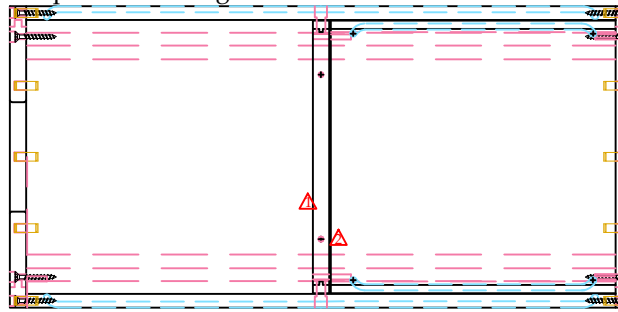
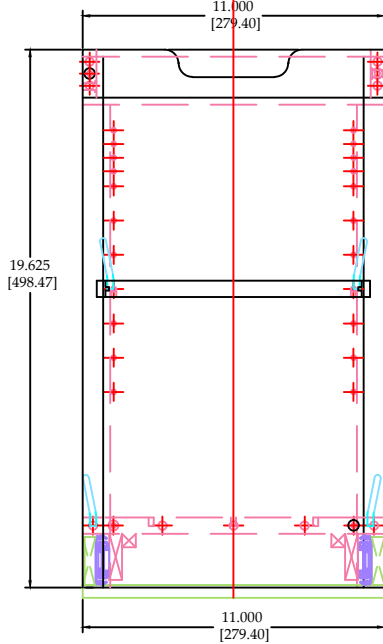
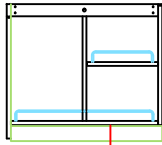

11" Pull Out App Option

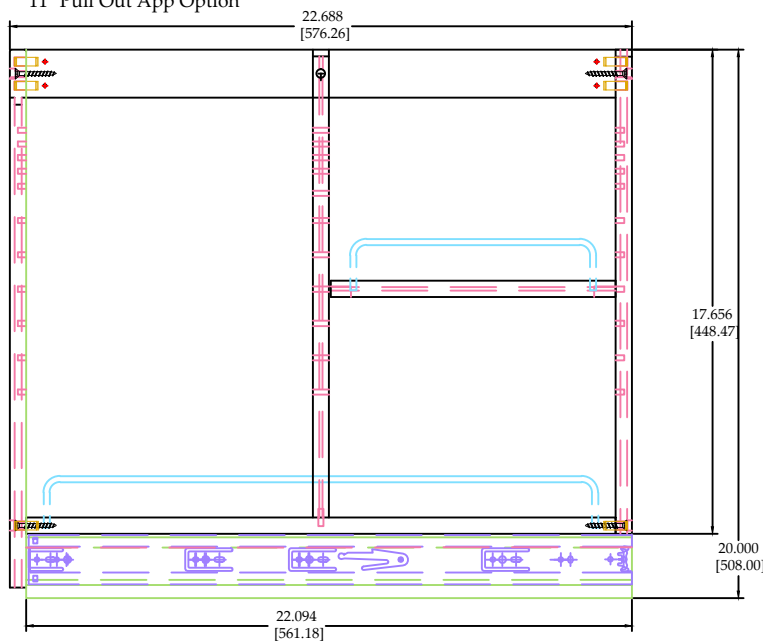

Material: Birch plywood and Birch/maple solids

Finish: 3 coat clear top coat finish
 Polished chrome rails and door mounting hardware
 Edgembanded sled assembly
 King 3M52 Soft Close slides

STATUS

05

11" Pull Out Vertical Divider

546.31.800

Rev/No	Project # or change Request #	Date	Signature	Checked
001	File updated	12.01.2011	NPG	RM

NOTICE
 THIS DRAWING AND ALL INFORMATION THEREON IS THE PROPERTY OF:



THIS DRAWING AND INFORMATION THEREON IS CONFIDENTIAL. MUST NOT MADE PUBLIC, COPIED OR USED TO DISADVANTAGE OF SAID HAFELE AMERICA CO. IT IS SUBJECT TO RETURN ON DEMAND.
 2008 HAFELE AMERICA, CO.

DATE:	SPECIFICATION
10.14.2011	MAT'L: See notes
SCALE:	FINISH: See notes
DRAWN BY: NPG	CUSTOMER APPROVAL
PUM APPROVAL DT	

Material: Birch plywood and Birch/maple solids

Finish: 3 coat clear top coat finish
Polished chrome rails and door mounting hardware
Edgembanded sled assembly
King 3M52 Soft Close slides

Materials and finish to be Spec'd Separately

△11NOV11-Divider upright width
changed to 9¹⁵/₁₆"

△11NOV11-Demi Shelf width
changed to 9¹⁵/₁₆"

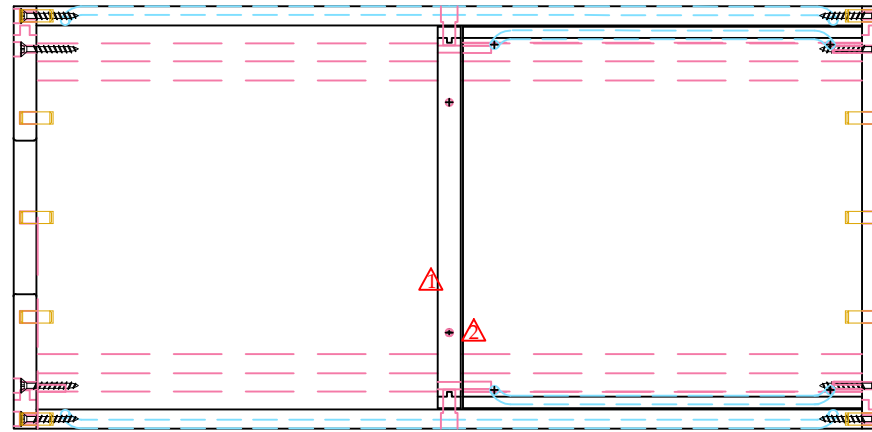
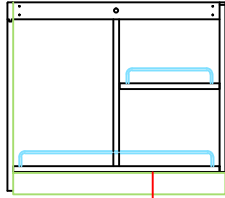

11" Pull Out App Option

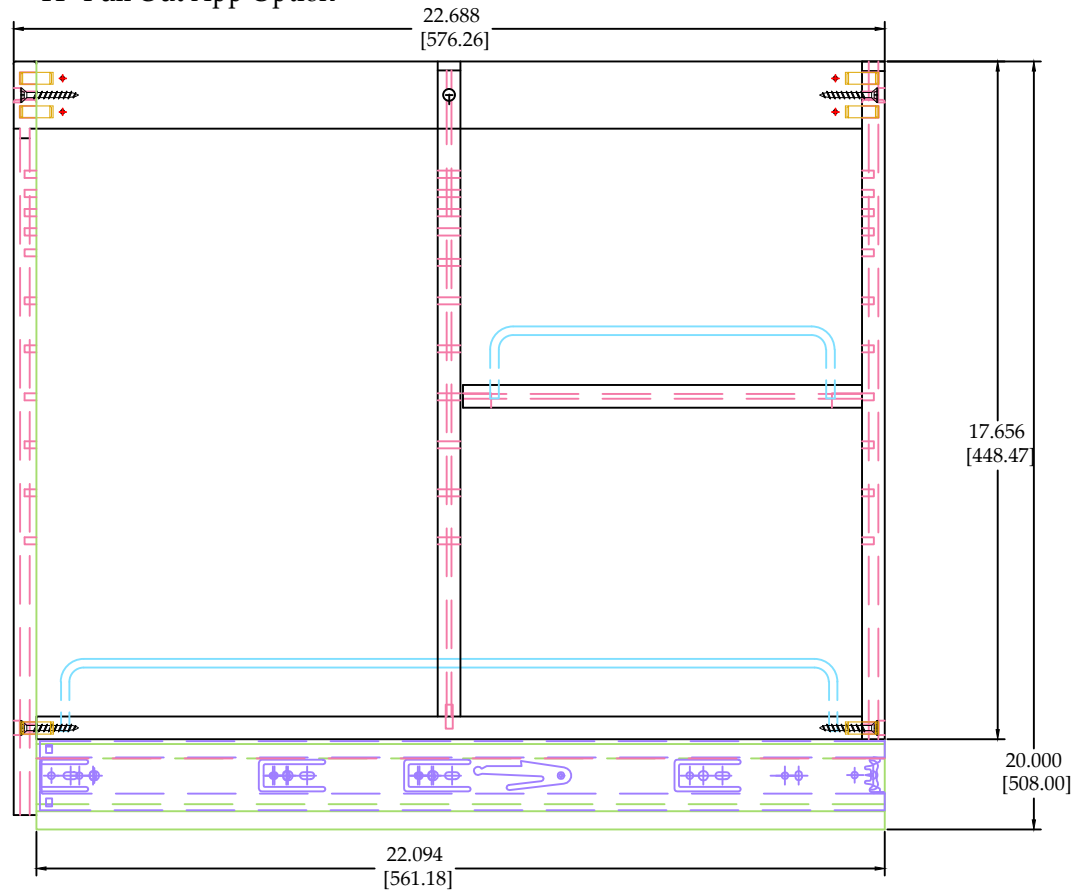
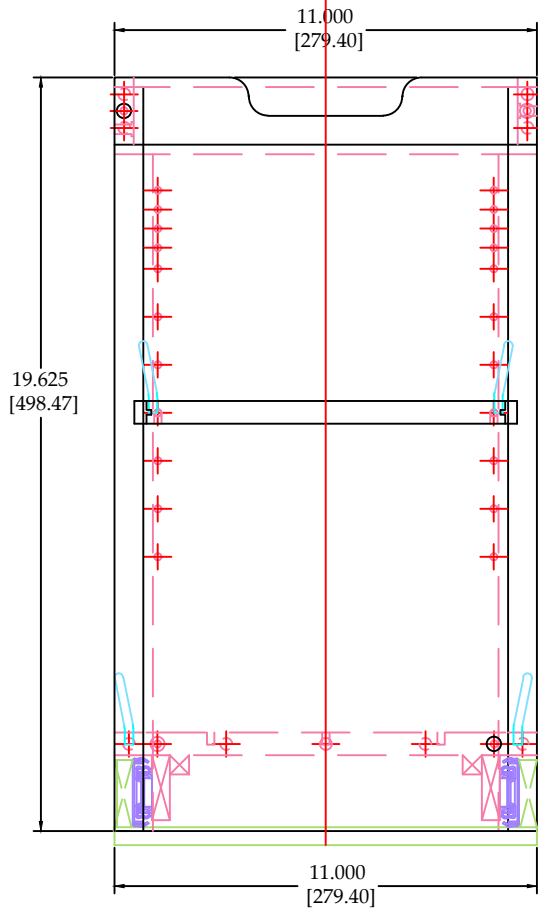

11" Pull Out App Option

Materials and finish to be Spec'd Separately

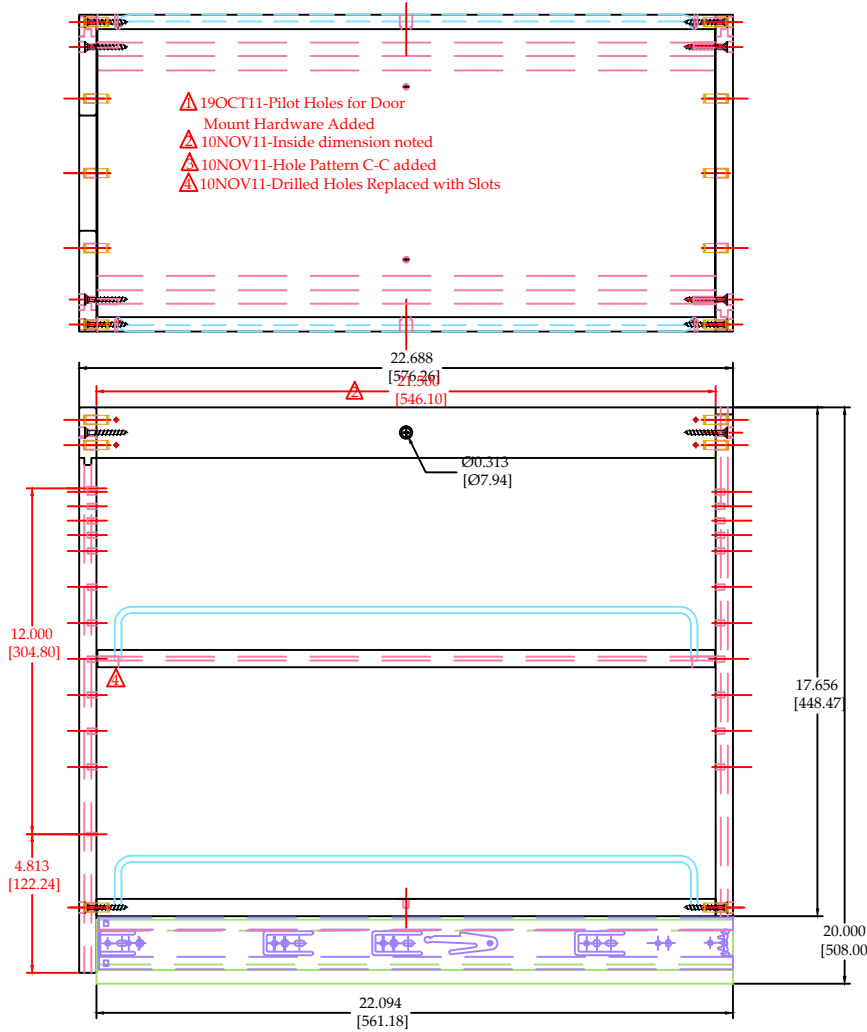
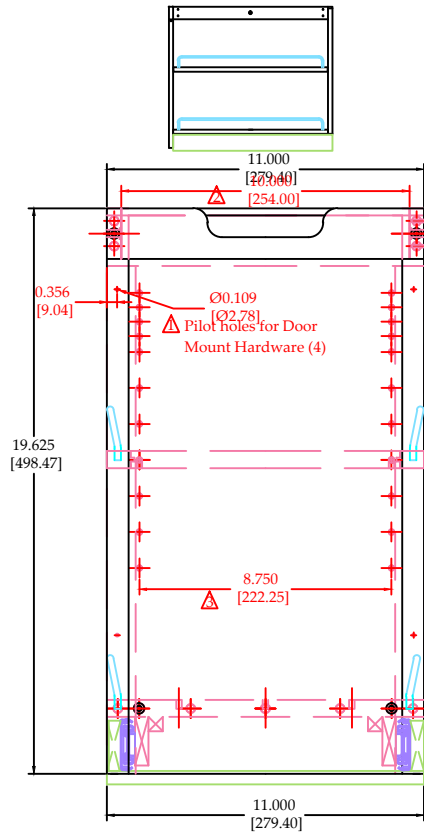

- ▲ 19OCT11-Pilot Holes for Door Mount Hardware Added
- ▲ 10NOV11-Inside dimension noted
- ▲ 10NOV11-Hole Pattern C-C added
- ▲ 10NOV11-Drilled Holes Replaced with Slots

Material: Birch plywood and Birch/maple solids

Finish: 3 coat clear top coat finish
 Polished chrome rails and door mounting hardware
 Edgebanded sled assembly
 King 3M52 Soft Close slides

STATUS
05

11" Pull Out App Option Basic	546.31.800
-------------------------------	------------

RevNo	Project # or change Request #	Date	Signature	Checked
001	File updated	12.01.2011	NPG	RM

NOTICE
 THIS DRAWING AND ALL INFORMATION THEREON IS THE PROPERTY OF:

HÄFELE

THIS DRAWING AND INFORMATION THEREON IS CONFIDENTIAL. MUST NOT BE MADE PUBLIC, COPIED OR USED TO DISADVANTAGE OF SAID HÄFELE AMERICA CO. IT IS SUBJECT TO RETURN ON DEMAND.
 2008 HAFELE AMERICA, CO.

DATE: 10.14.2011	SPECIFICATION
SCALE:	MAT'L: See notes
DRAWN BY: NPG	FINISH: See notes
PUM APPROVAL DT	CUSTOMER APPROVAL

Drawing file: 546.31.800-HAC-11in.Ap Pullout Unit-Basic.REV.001.dwg

11" Pull Out App Option

Materials and finish to be Spec'd Separately

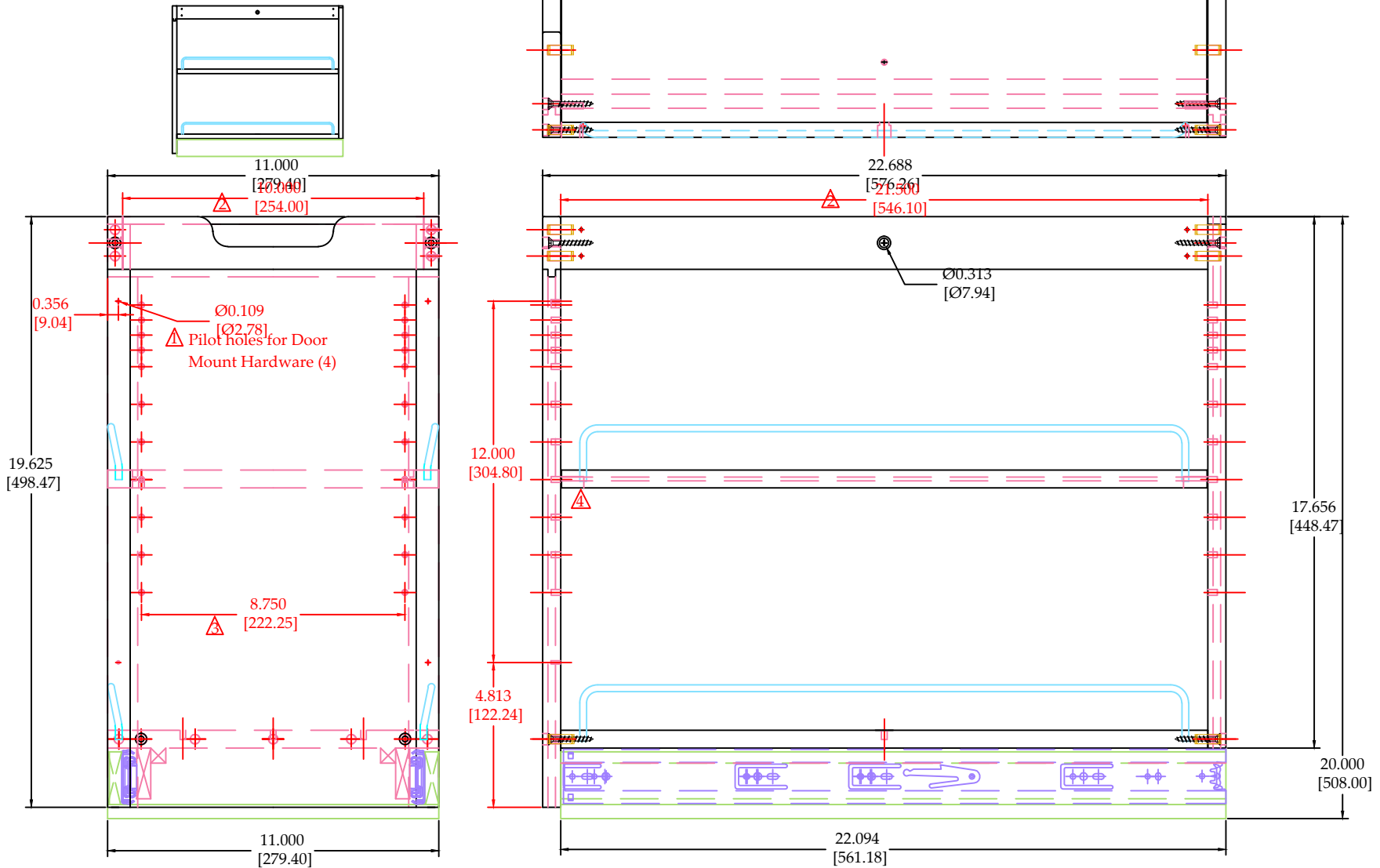

11" Container Shelf

Materials and finish to be Spec'd Separately
 Stainless Containers to be Specified
 and Includes (Hole Cut Out Dimensions
 to Match Containers)
 (2 per Unit)

- ⚠ 10NOV11-Overall width from 11" to 9-15/16"
- ⚠ 10NOV11-Drilled Holes Replaced with Slots

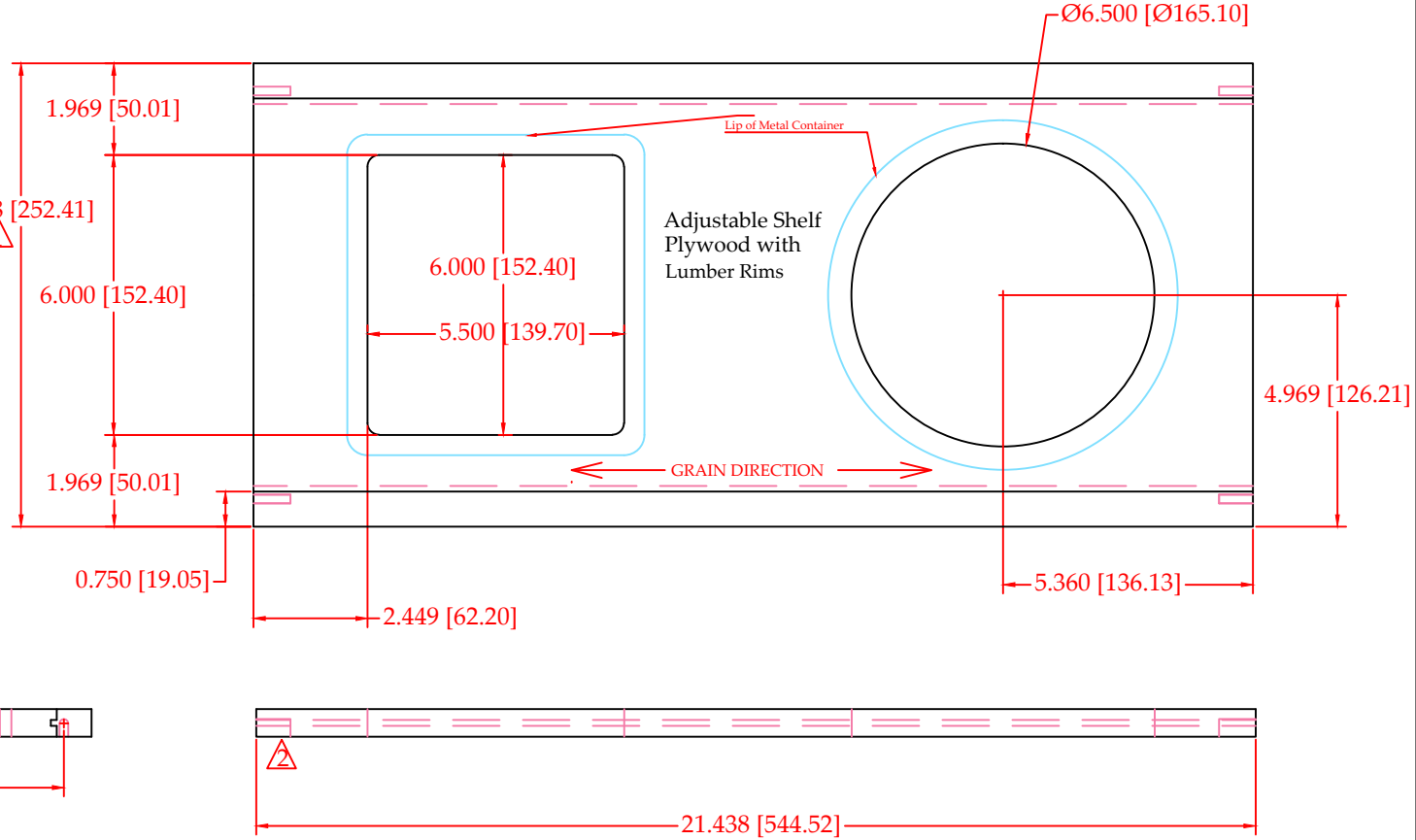

Material: Birch plywood and Birch/maple solids

Finish: 3 coat clear top coat finish
 Polished chrome rails and door mounting hardware
 Edgembanded sled assembly
 King 3M52 Soft Close slides

STATUS
05

11" Pull Out Container Shelf	546.31.830
------------------------------	------------

NOTICE
 THIS DRAWING AND ALL INFORMATION THEREON IS THE PROPERTY OF:

HÄFELE

THIS DRAWING AND INFORMATION THEREON IS CONFIDENTIAL. MUST NOT BE MADE PUBLIC, COPIED OR USED TO DISADVANTAGE OF SAID HÄFELE AMERICA CO. IT IS SUBJECT TO RETURN ON DEMAND.
 2008 HAFELE AMERICA, CO.

DATE:	10.14.2011
SCALE:	
DRAWN BY:	NPG
PUM APPROVAL:	DT

SPECIFICATION
MAT'L: See notes
FINISH: See notes
CUSTOMER APPROVAL

RevNo	Project # or change Request #	Date	Signature	Checked
001	File updated	12.01.2011	NPG	RM

Materials and finish to be Spec'd Separately
Stainless Containers to be Specified
and Included (Hold Cut Out Dimensions
to Match Containers)

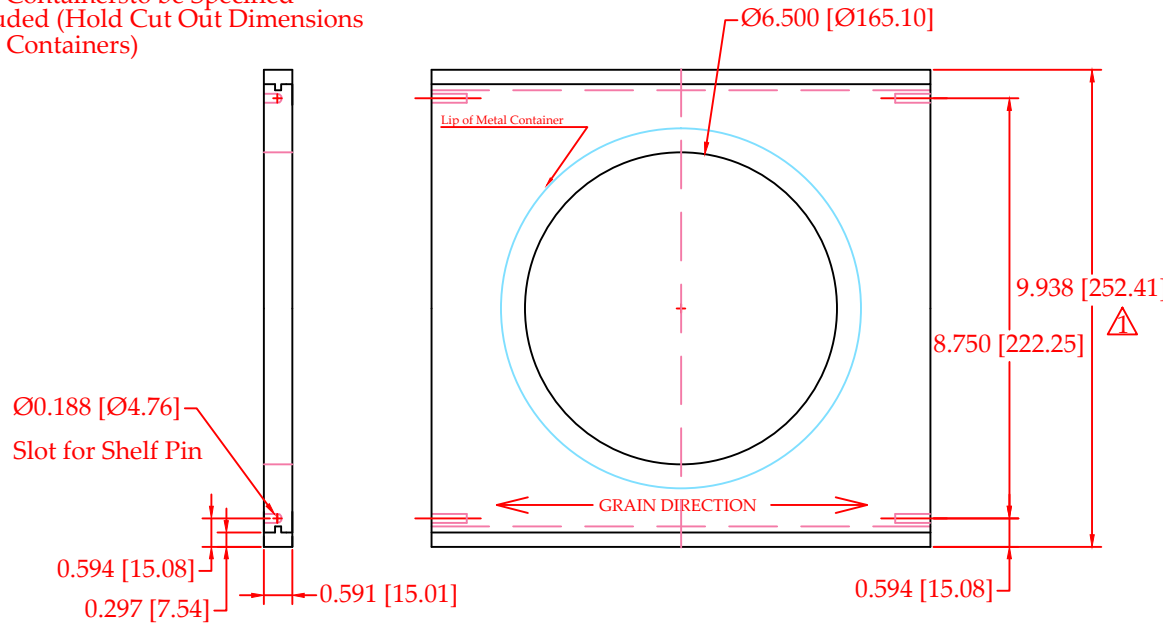

DEMI CONTAINER SHELF Ap-11" Unit
(for Use With Vertical Divider Ap)

- ⚠ 11NOV11-Overall Width Decreased
- ⚠ 10NOV11-Drilled Holes Replaced with Slots

Material: Birch plywood and Birch/maple solids

Finish: 3 coat clear top coat finish
Polished chrome rails and door mounting hardware
Edgembanded sled assembly
King 3M52 Soft Close slides

STATUS
05

11" Pull Out Container Shelf		546.31.831
DATE:	10.14.2011	SPECIFICATION
SCALE:		MAT'L: See notes
DRAWN BY:	NPG	FINISH: See notes
PUM APPROVAL	DT	CUSTOMER APPROVAL

NOTICE
THIS DRAWING AND ALL INFORMATION THEREON IS THE PROPERTY OF:

THIS DRAWING AND INFORMATION THEREON IS CONFIDENTIAL. MUST NOT BE MADE PUBLIC, COPIED OR USED TO DISADVANTAGE OF SAID HAFELE AMERICA CO. IT IS SUBJECT TO RETURN ON DEMAND.
2008 HAFELE AMERICA, CO.

RevNo	Project # or change Request #	Date	Signature	Checked
001	File updated	12.01.2011	NPG	RM

CUTLERY TRAY Ap-11" Unit

Materials and finish to be Spec'd Separately
 ⚠ 11NOV11-Overall length and width increased

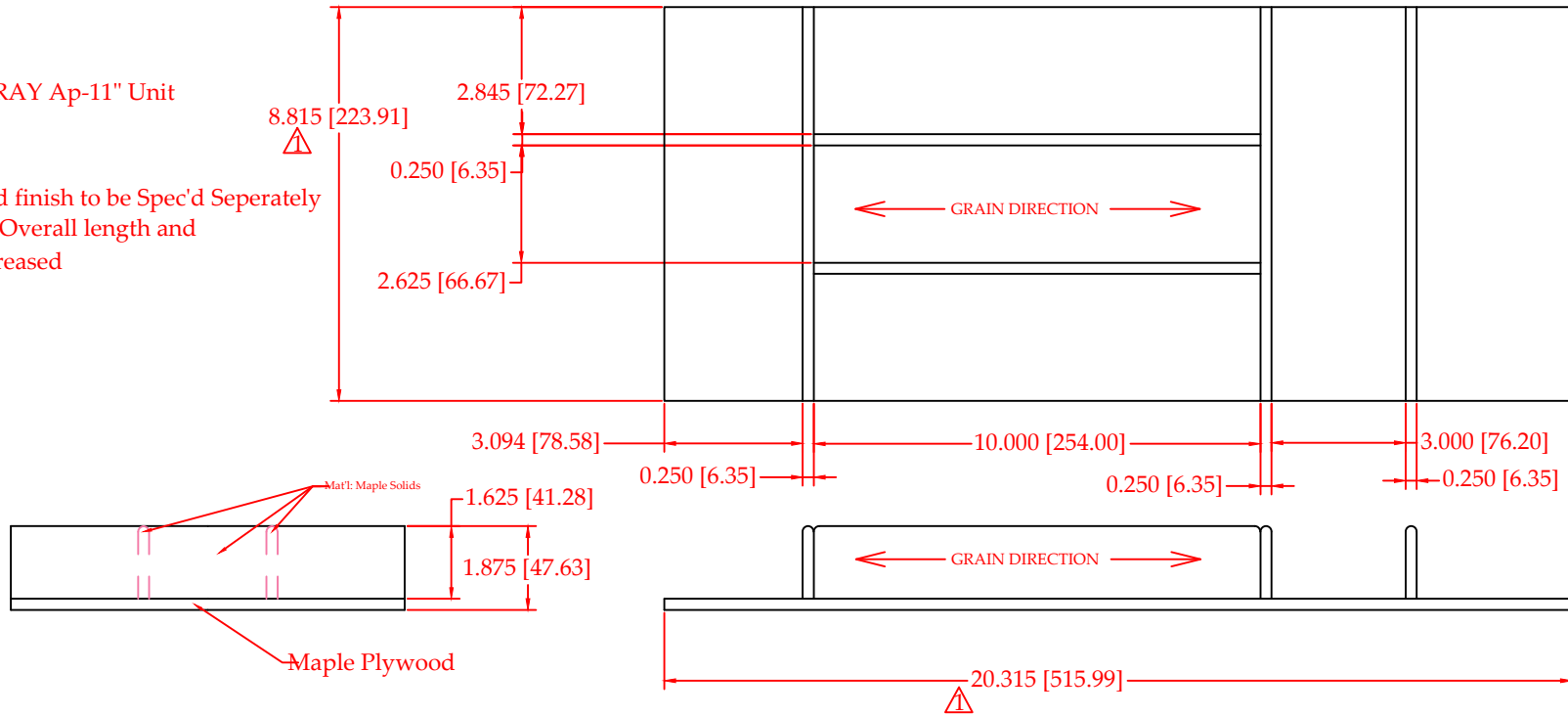

Material: Birch plywood and Birch/maple solids

Finish: 3 coat clear top coat finish
 Polished chrome rails and door mounting hardware
 Edgebanded sled assembly
 King 3M52 Soft Close slides

STATUS

05

11" Pull Out Cutlery Tray

546.31.840

Rev/No	Project # or change Request #	Date	Signature	Checked
001	File updated	12.01.2011	NPG	RM

NOTICE
 THIS DRAWING AND ALL INFORMATION THEREON IS THE PROPERTY OF:

HÄFELE

THIS DRAWING AND INFORMATION THEREON IS CONFIDENTIAL. MUST NOT MADE PUBLIC, COPIED OR USED TO DISADVANTAGE OF SAID HÄFELE AMERICA CO. IT IS SUBJECT TO RETURN ON DEMAND.
 2008 HÄFELE AMERICA, CO.

DATE:	SPECIFICATION
10.14.2011	
SCALE:	MAT'L: See notes
DRAWN BY: NPG	FINISH: See notes
PUM APPROVAL DT	CUSTOMER APPROVAL

DEMI CUTLERY TRAY Ap-11" Unit
(for Use With Vertical Divider Ap)

Materials and finish to be Spec'd Separately
 ▲ 11NOV11-Overall length and width increased

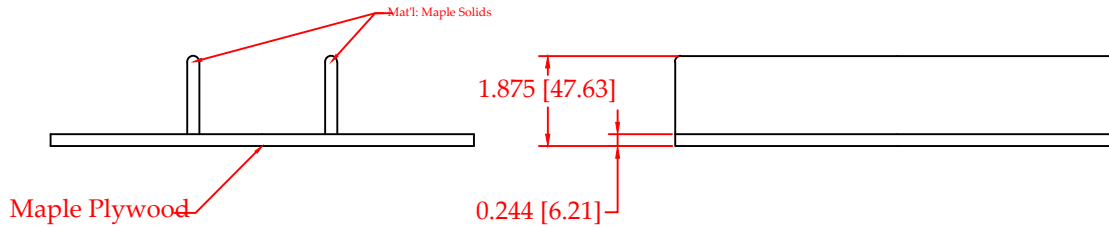
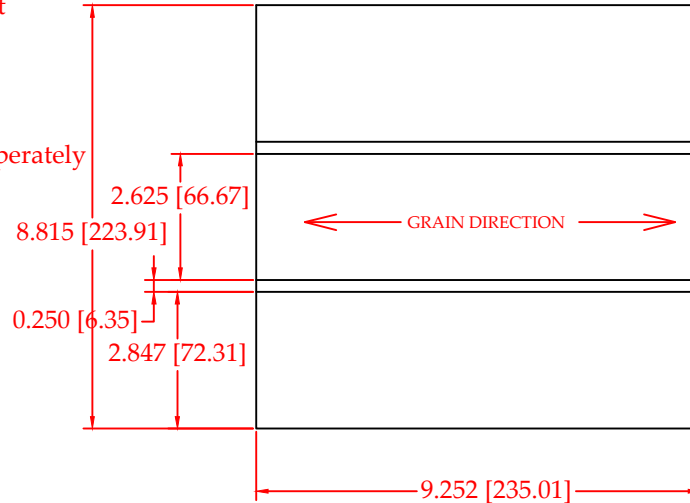
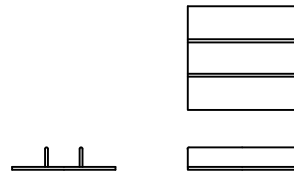

Material: Birch plywood and Birch/maple solids

Finish: 3 coat clear top coat finish
 Polished chrome rails and door mounting hardware
 Edgembanded sled assembly
 King 3M52 Soft Close slides

STATUS
05

11" Pull Out Demi Cutlery Tray	546.31.841
--------------------------------	------------

RevNo	Project # or change Request #	Date	Signature	Checked
001	File updated	12.01.2011	NPG	RM

NOTICE
 THIS DRAWING AND ALL INFORMATION THEREON IS THE PROPERTY OF:

HÄFELE

THIS DRAWING AND INFORMATION THEREON IS CONFIDENTIAL. MUST NOT BE MADE PUBLIC, COPIED OR USED TO DISADVANTAGE OF SAID HÄFELE AMERICA CO. IT IS SUBJECT TO RETURN ON DEMAND.
 2008 HAFELE AMERICA, CO.

DATE: 10.14.2011	SPECIFICATION
SCALE:	MAT'L: See notes
DRAWN BY: NPG	FINISH: See notes
PUM APPROVAL: DT	CUSTOMER APPROVAL

CUTTING BOARD Ap-11" Unit

Materials and finish to be Spec'd Separately
 ⚠ 11NOV11-Overall length and width increased by 1/8"

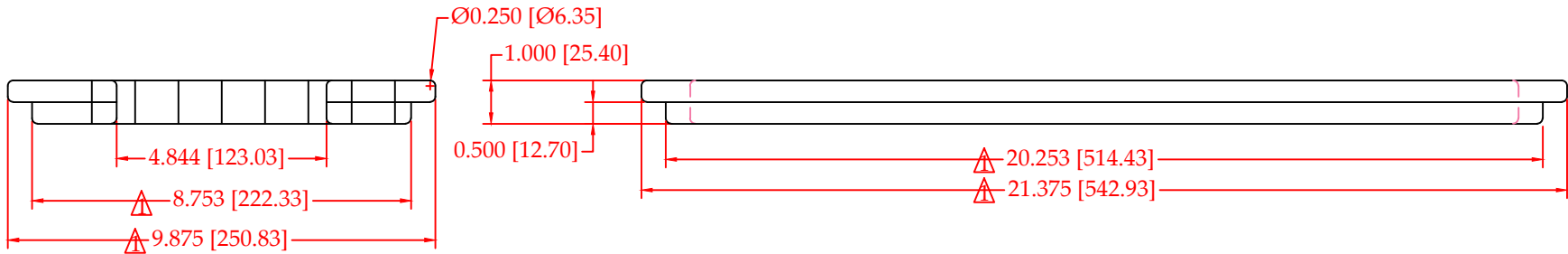
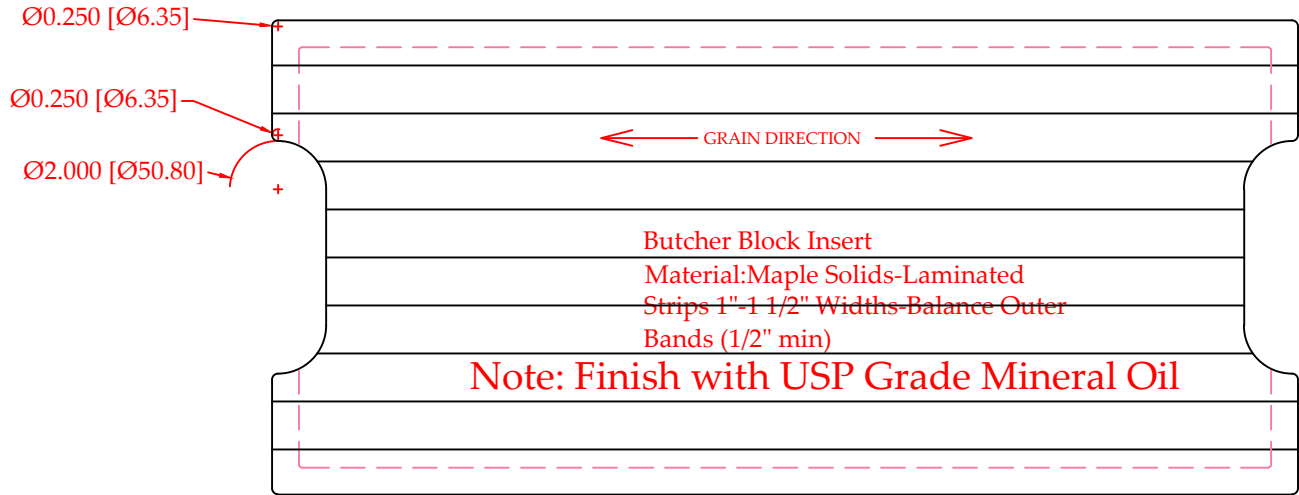

Material: Birch plywood and Birch/maple solids

Finish: 3 coat clear top coat finish
 Polished chrome rails and door mounting hardware
 Edgembanded sled assembly
 King 3M52 Soft Close slides

STATUS
05

11" Pull Out Cutting Board	546.31.850
----------------------------	------------

RevNo	Project # or change Request #	Date	Signature	Checked
001	File updated	12.01.2011	NPG	RM

NOTICE
 THIS DRAWING AND ALL INFORMATION THEREON IS THE PROPERTY OF:

HÄFELE

THIS DRAWING AND INFORMATION THEREON IS CONFIDENTIAL. MUST NOT MADE PUBLIC, COPIED OR USED TO DISADVANTAGE OF SAID HÄFELE AMERICA CO. IT IS SUBJECT TO RETURN ON DEMAND.
 2008 HAFELE AMERICA, CO.

DATE: 10.14.2011	SPECIFICATION
SCALE:	MAT'L: See notes
DRAWN BY: NPG	FINISH: See notes
PUM APPROVAL DT	CUSTOMER APPROVAL

DEMI CUTTING BOARD Ap-11"Unit
(for Use With Vertical Divider Ap)

Materials and finish to be Spec'd Separately
 ⚠ 10NOV11-Length and Width Increased

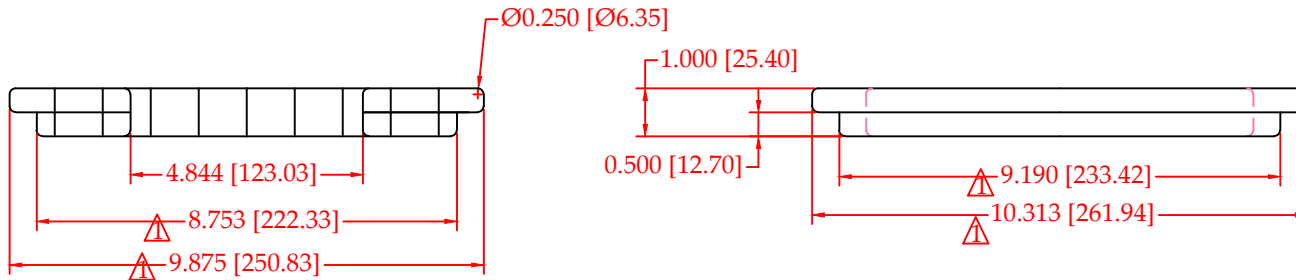
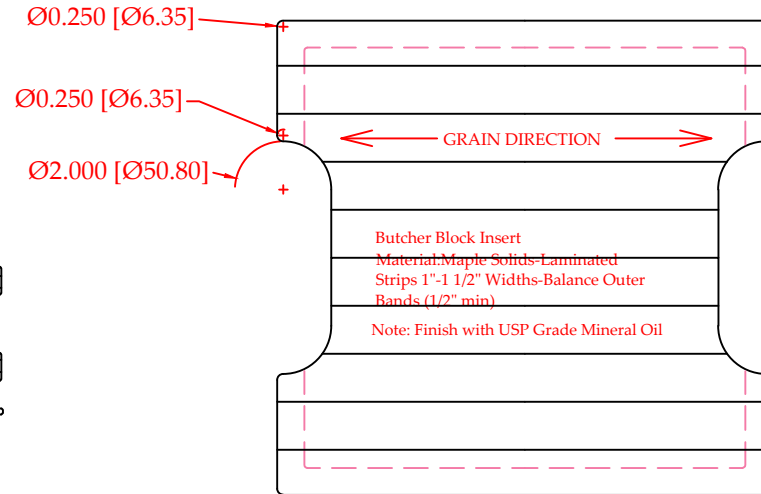
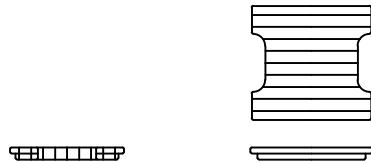

Material: Birch plywood and Birch/maple solids

Finish: 3 coat clear top coat finish
 Polished chrome rails and door mounting hardware
 Edgembanded sled assembly
 King 3M52 Soft Close slides

STATUS
05

11" Pull Out Demi Cutting Board		546.31.851
DATE:	10.14.2011	SPECIFICATION
SCALE:		MAT'L: See notes
DRAWN BY:	NPG	FINISH: See notes
PUM APPROVAL	DT	CUSTOMER APPROVAL

RevNo	Project # or change Request #	Date	Signature	Checked
001	File updated	12.01.2011	NPG	RM

NOTICE
 THIS DRAWING AND ALL INFORMATION THEREON IS THE PROPERTY OF:

HÄFELE

THIS DRAWING AND INFORMATION THEREON IS CONFIDENTIAL. MUST NOT BE MADE PUBLIC, COPIED OR USED TO DISADVANTAGE OF SAID HÄFELE AMERICA CO. IT IS SUBJECT TO RETURN ON DEMAND.
 2008 HAFELE AMERICA, CO.

DEMI-DROP-IN TRAY Ap-11"Unit
(for Use With Vertical Divider Ap)

Materials and finish to be Spec'd Separately
 ⚠ 10NOV11-Length and Width Increased

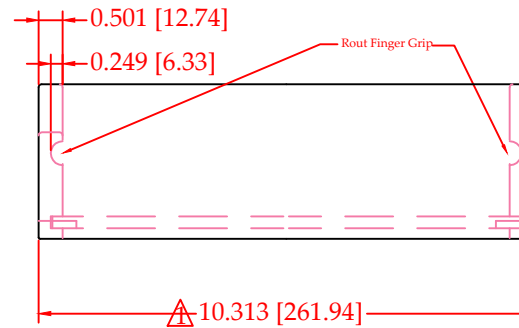
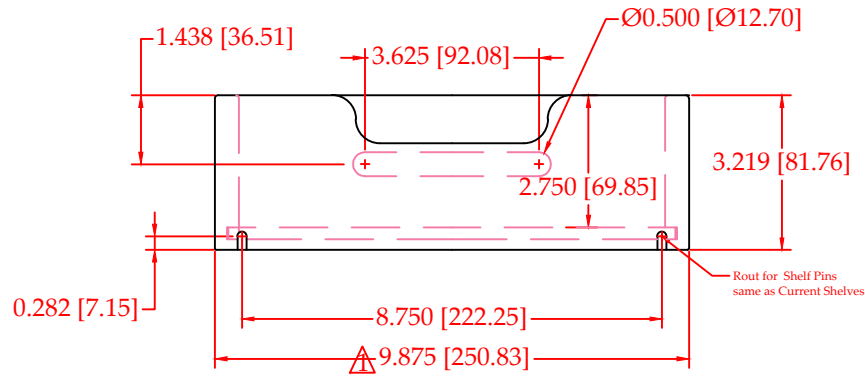
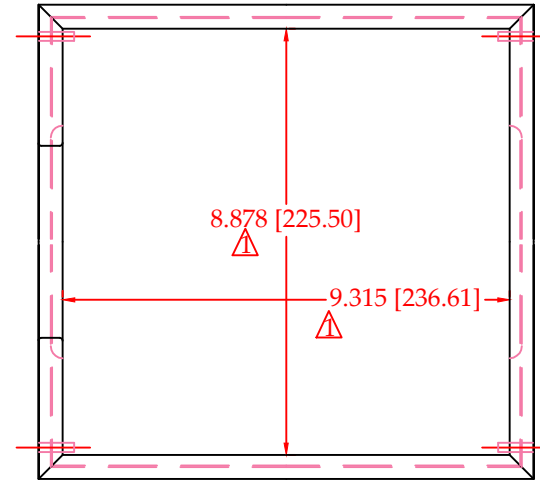
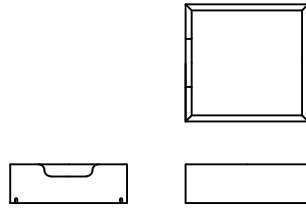

Material: Birch plywood and Birch/maple solids

Finish: 3 coat clear top coat finish
 Polished chrome rails and door mounting hardware
 Edgeworked sled assembly
 King 3M52 Soft Close slides

STATUS
05

11" Pull Out Demi Drop on Tray	546.31.860
--------------------------------	------------

RevNo	Project # or change Request #	Date	Signature	Checked
001	File updated	12.01.2011	NPG	RM

NOTICE
 THIS DRAWING AND ALL INFORMATION THEREON IS THE PROPERTY OF:

THIS DRAWING AND INFORMATION THEREON IS CONFIDENTIAL. MUST NOT BE MADE PUBLIC, COPIED OR USED TO DISADVANTAGE OF SAID HAFELE AMERICA CO. IT IS SUBJECT TO RETURN ON DEMAND.
 2008 HAFELE AMERICA, CO.

DATE: 10.14.2011	SPECIFICATION
SCALE:	MAT'L: See notes
DRAWN BY: NPG	FINISH: See notes
PUM APPROVAL: DT	CUSTOMER APPROVAL

Drop-in App Tray
 Material-Solid lumber sides
 Plywood Bottom
 Materials and finish to be Spec'd Separately
 ⚠ 11NOV11-Overall length and width increased by 1/8"

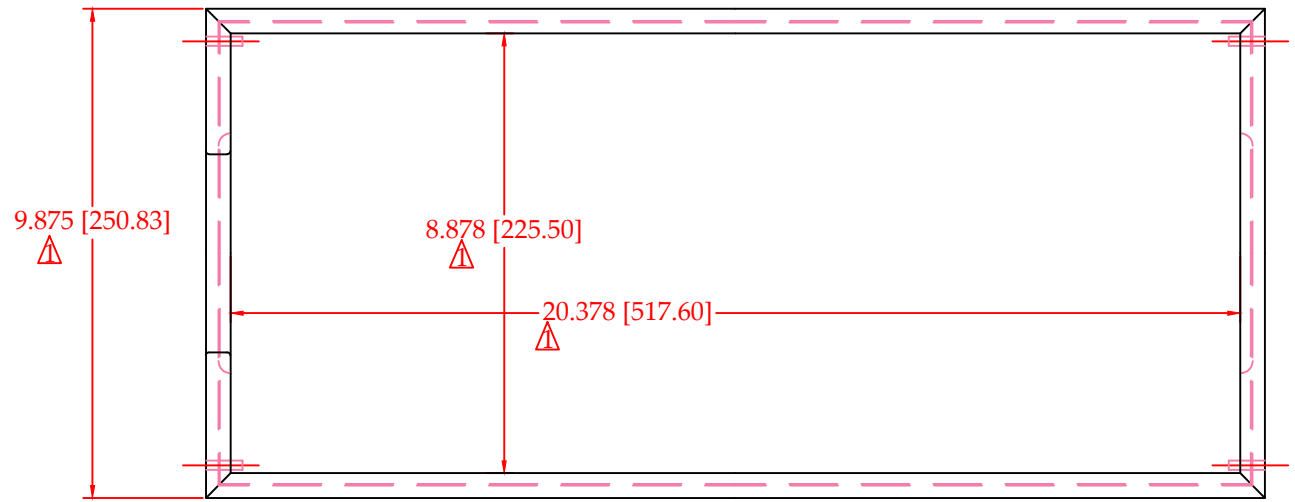

Note: DRAWING IS FOR PROTOTYPE USE ONLY

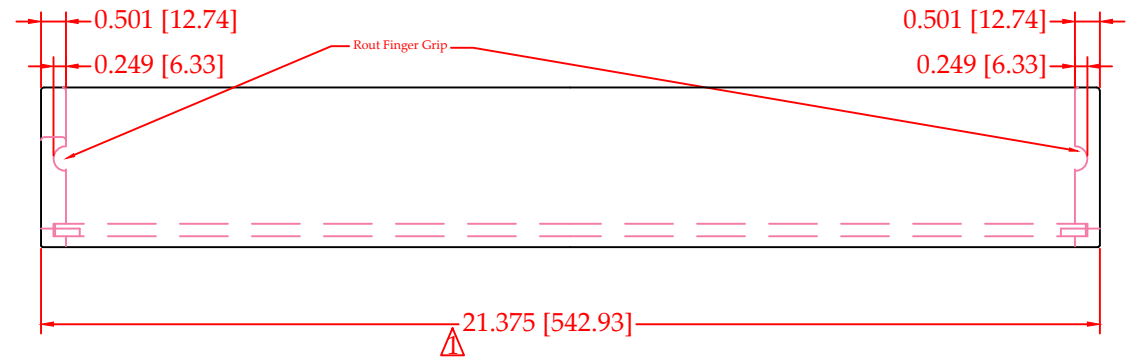
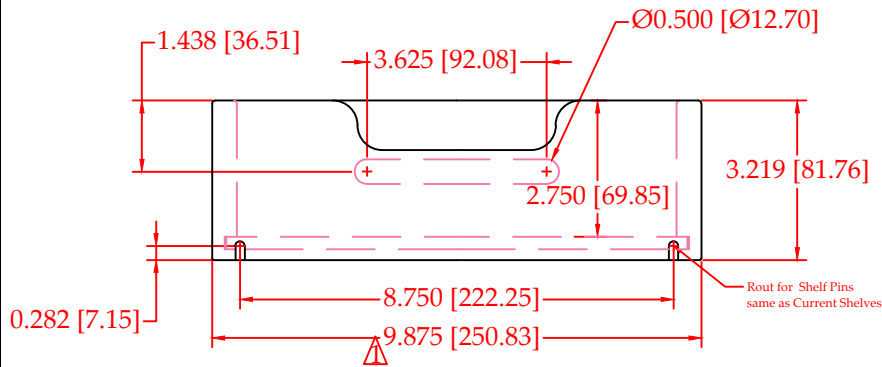

Material: Birch plywood and Birch/maple solids

Finish: 3 coat clear top coat finish
 Polished chrome rails and door mounting hardware
 Edgembanded sled assembly
 King 3M52 Soft Close slides

STATUS
05
11" Pull Out Drop in Tray
546.31.861

RevNo	Project # or change Request #	Date	Signature	Checked
001	File updated	12.01.2011	NPG	RM

NOTICE
 THIS DRAWING AND ALL INFORMATION THEREON IS THE PROPERTY OF:

THIS DRAWING AND INFORMATION THEREON IS CONFIDENTIAL. MUST NOT BE MADE PUBLIC, COPIED OR USED TO DISADVANTAGE OF SAID HAFELE AMERICA CO. IT IS SUBJECT TO RETURN ON DEMAND.
 2008 HAFELE AMERICA, CO.

DATE:	10.14.2011	SPECIFICATION
SCALE:		MAT'L: See notes
DRAWN BY:	NPG	FINISH: See notes
PUM APPROVAL	DT	CUSTOMER APPROVAL

**DEMI SPICE TRAY Ap-11"Unit
(for Use With Vertical Divider Ap)**

Materials and finish to be Spec'd Separately

⚠ 11NOV11-Overall length and width increased

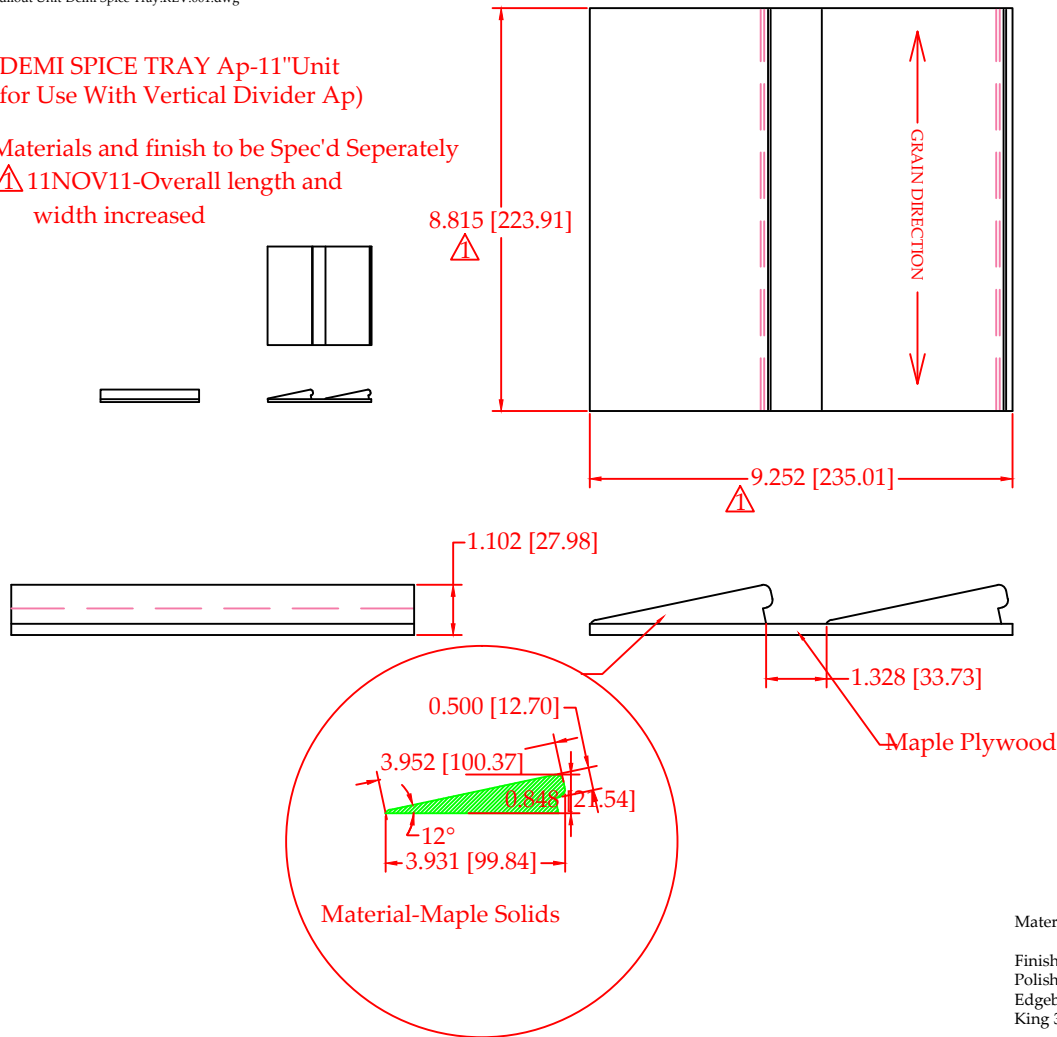

Material: Birch plywood and Birch/maple solids

Finish: 3 coat clear top coat finish
Polished chrome rails and door mounting hardware
Edgebanded sled assembly
King 3M52 Soft Close slides

STATUS
05

11" Pull Out Demi Spice Tray	546.31.870
------------------------------	------------

Rev/No	Project # or change Request #	Date	Signature	Checked
001	File updated	12.01.2011	NPG	RM

NOTICE
THIS DRAWING AND ALL INFORMATION THEREON IS THE PROPERTY OF:

HÄFELE

THIS DRAWING AND INFORMATION THEREON IS CONFIDENTIAL. MUST NOT MADE PUBLIC, COPIED OR USED TO DISADVANTAGE OF SAID HÄFELE AMERICA CO. IT IS SUBJECT TO RETURN ON DEMAND.
2008 HÄFELE AMERICA, CO.

DATE: 10.14.2011	SPECIFICATION
SCALE:	MAT'L: See notes
DRAWN BY: NPG	FINISH: See notes
PUM APPROVAL DT	CUSTOMER APPROVAL

ROLL MANAGEMENT Ap-11" Unit

Materials and finish to be Spec'd Separately
 ⚠ 11NOV11-Overall length and width increased

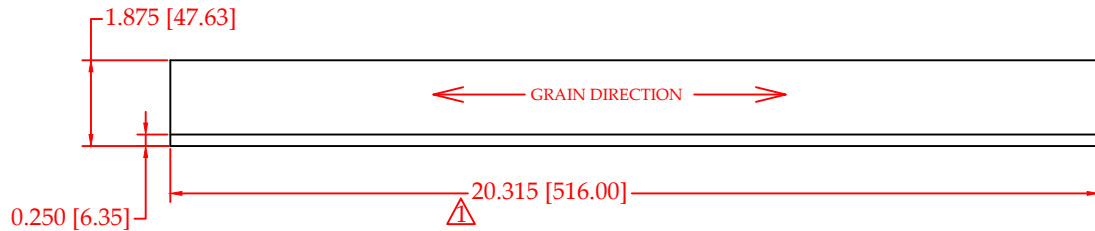
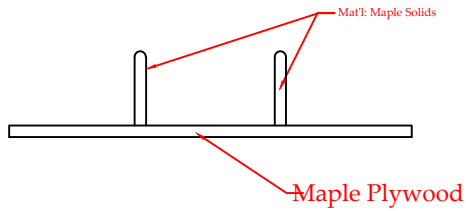
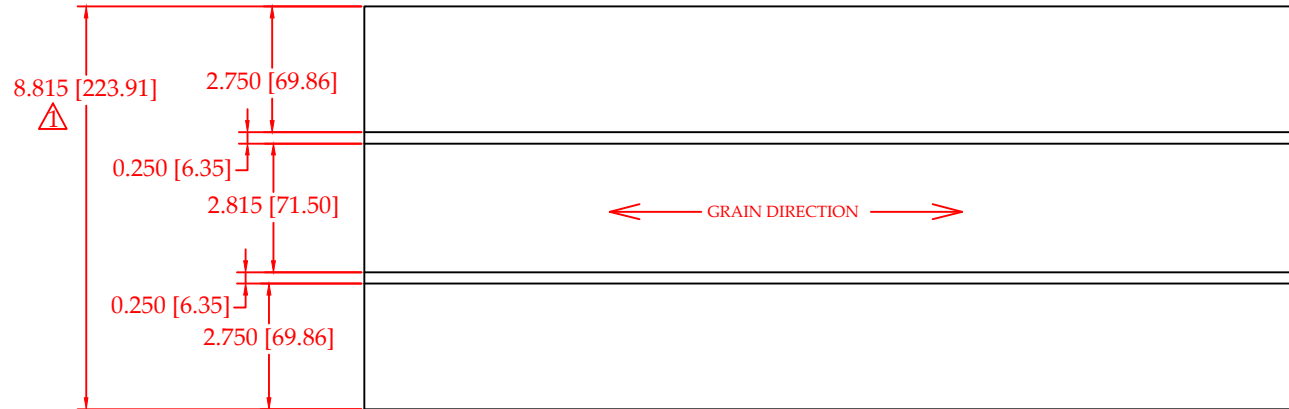

Material: Birch plywood and Birch/maple solids

Finish: 3 coat clear top coat finish
 Polished chrome rails and door mounting hardware
 Edgebanded sled assembly
 King 3M52 Soft Close slides

STATUS
05
11" Pull Out Roll Mangmnt
546.31.871

Rev/No	Project # or change Request #	Date	Signature	Checked
001	File updated	12.01.2011	NPG	RM

NOTICE
 THIS DRAWING AND ALL INFORMATION THEREON IS THE PROPERTY OF:
HÄFELE
 THIS DRAWING AND INFORMATION THEREON IS CONFIDENTIAL. MUST NOT MADE PUBLIC, COPIED OR USED TO DISADVANTAGE OF SAID HÄFELE AMERICA CO. IT IS SUBJECT TO RETURN ON DEMAND.
 2008 HÄFELE AMERICA, CO.

DATE: 10.14.2011	SPECIFICATION
SCALE:	MAT'L: See notes
DRAWN BY: NPG	FINISH: See notes
PUM APPROVAL DT	CUSTOMER APPROVAL

SPICE TRAY Ap-11" unit

Materials and finish to be Spec'd Separately

⚠ 11NOV11-Overall length and width increased

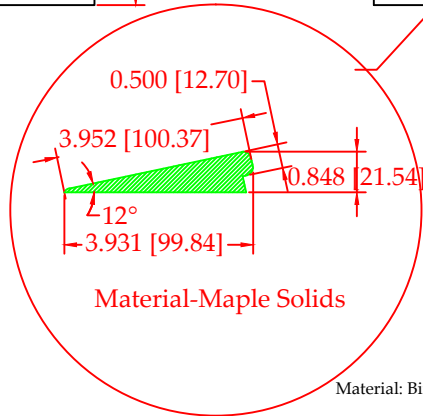
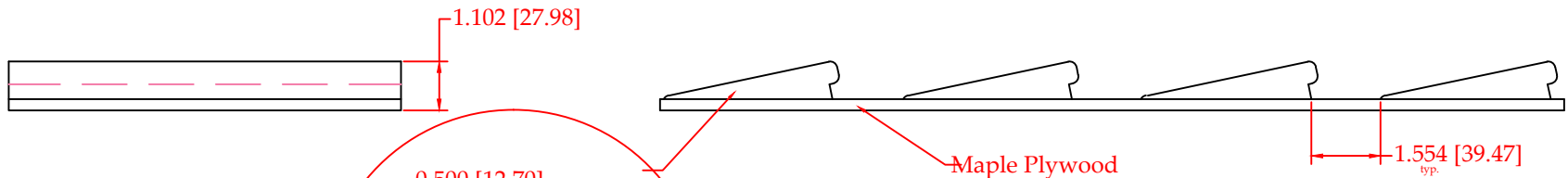
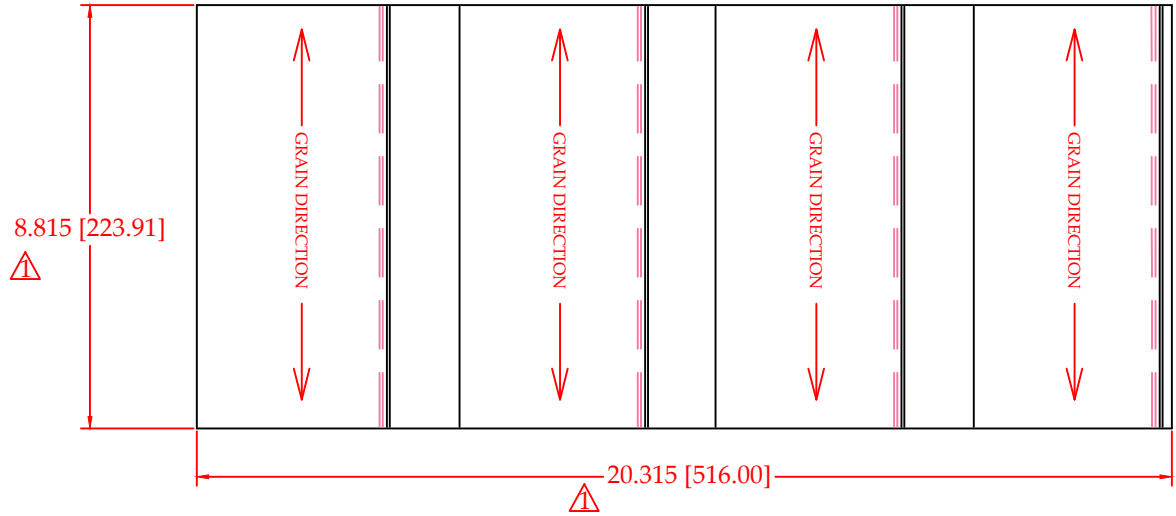

Material: Birch plywood and Birch/maple solids

Finish: 3 coat clear top coat finish
 Polished chrome rails and door mounting hardware
 Edgembanded sled assembly
 King 3M52 Soft Close slides

STATUS
05

11" Pull Out Spice Tray		546.31.871
DATE:	10.14.2011	SPECIFICATION
SCALE:		MAT'L: See notes
DRAWN BY:	NPG	FINISH: See notes
PUM APPROVAL	DT	CUSTOMER APPROVAL

RevNo	Project # or change Request #	Date	Signature	Checked
001	File updated	12.01.2011	NPG	RM

NOTICE
 THIS DRAWING AND ALL INFORMATION THEREON IS THE PROPERTY OF:

THIS DRAWING AND INFORMATION THEREON IS CONFIDENTIAL. MUST NOT BE MADE PUBLIC, COPIED OR USED TO DISADVANTAGE OF SAID HAFELE AMERICA CO. IT IS SUBJECT TO RETURN ON DEMAND.
 2008 HAFELE AMERICA, CO.

KNIFE TRAY Ap-11" Unit

Materials and finish to be Spec'd Separately

⚠ 11NOV11-Overall length and width increased

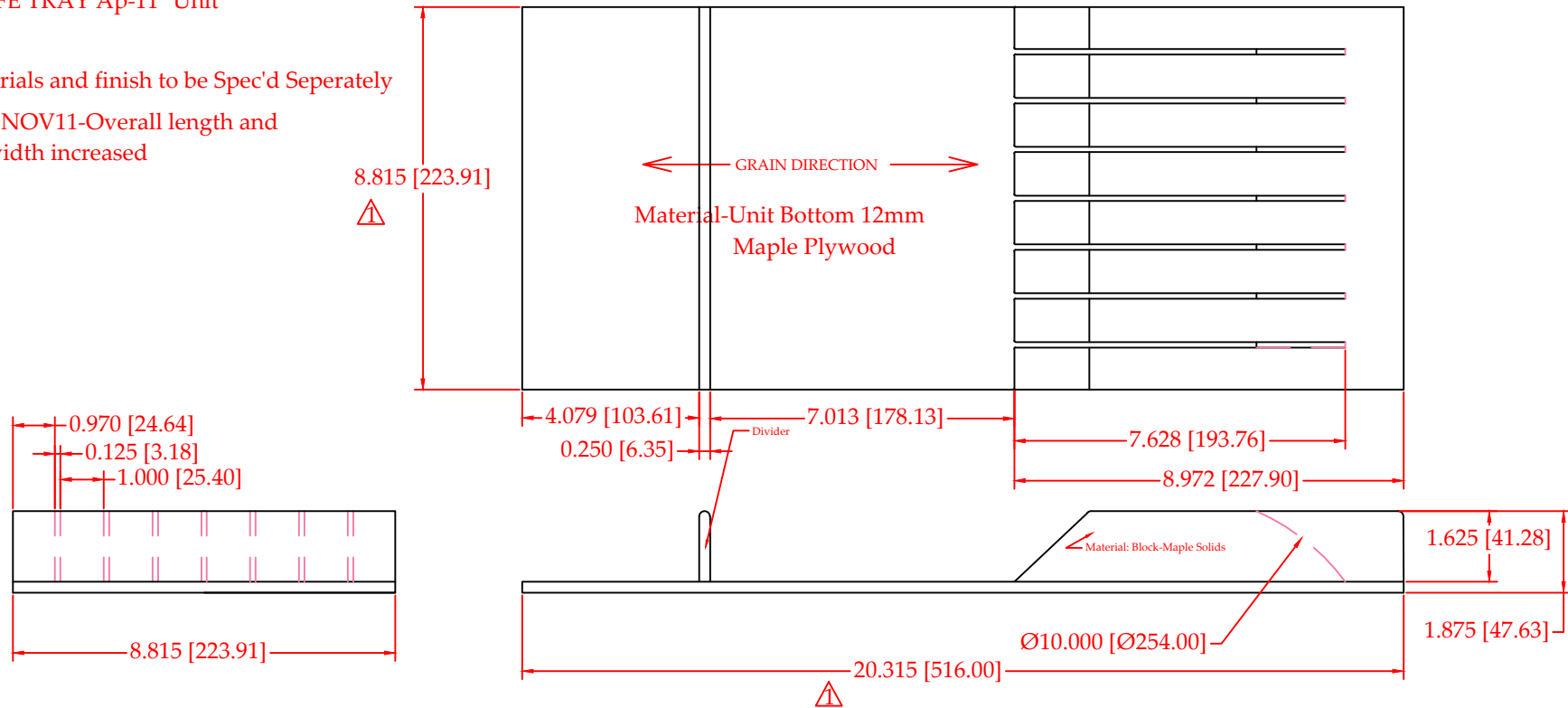

Material: Birch plywood and Birch/maple solids

Finish: 3 coat clear top coat finish
 Polished chrome rails and door mounting hardware
 Edgembanded sled assembly
 King 3M52 Soft Close slides

STATUS
05
11" Pull Out Knife Tray
546.31.880

RevNo	Project # or change Request #	Date	Signature	Checked
001	File updated	12.01.2011	NPG	RM

NOTICE
 THIS DRAWING AND ALL INFORMATION THEREON IS THE PROPERTY OF:

HÄFELE

THIS DRAWING AND INFORMATION THEREON IS CONFIDENTIAL. MUST NOT BE MADE PUBLIC, COPIED OR USED TO DISADVANTAGE OF SAID HÄFELE AMERICA CO. IT IS SUBJECT TO RETURN ON DEMAND.
 2008 HAFELE AMERICA, CO.

DATE:	10.14.2011	SPECIFICATION
SCALE:		MAT'L: See notes
DRAWN BY:	NPG	FINISH: See notes
PUM APPROVAL	DT	CUSTOMER APPROVAL

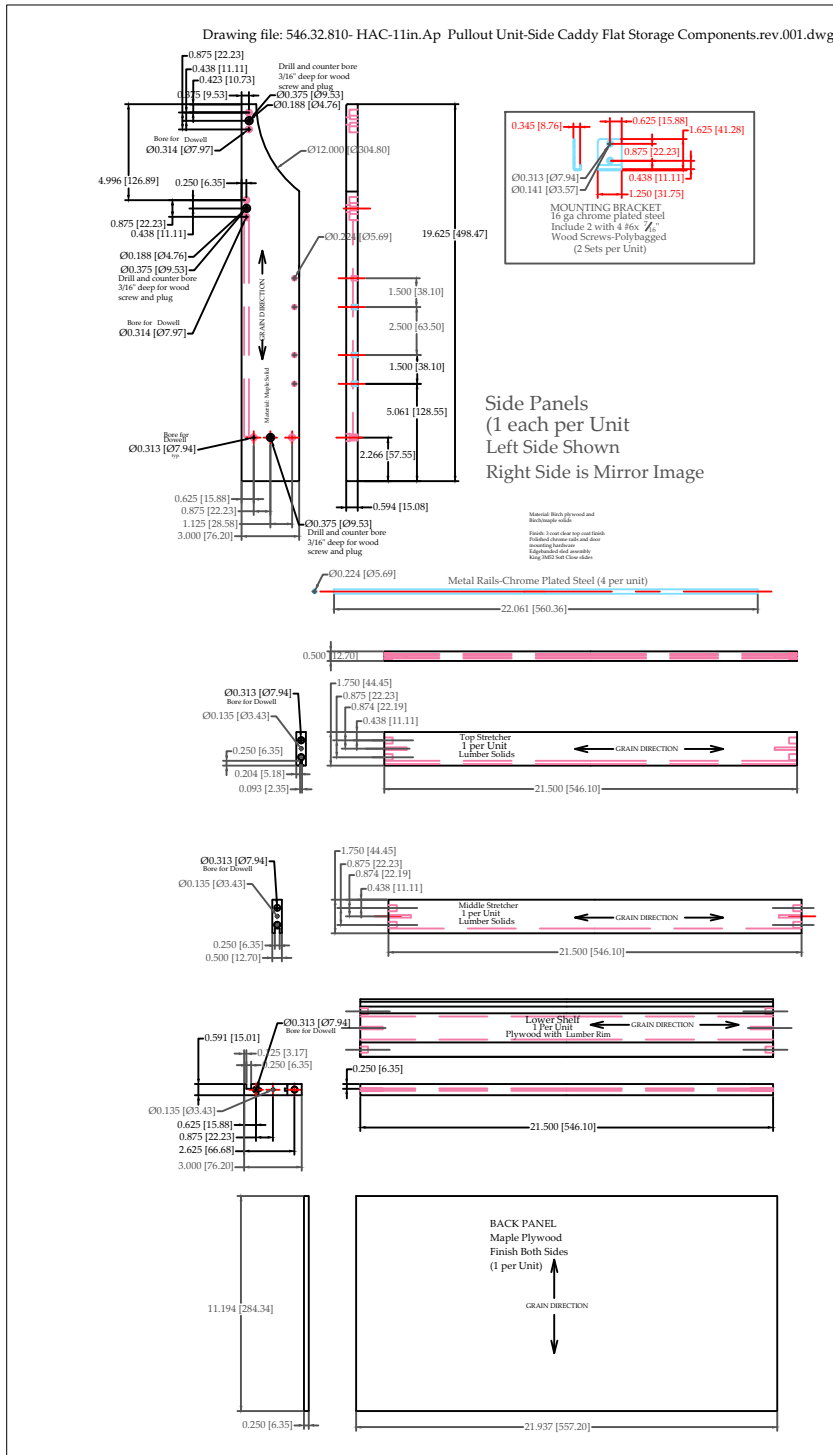

STATUS
05

11in Pullout Unit-Side Caddy Flat Storage Components.REV.001		546.32.810
<p>NOTICE THIS DRAWING AND ALL INFORMATION THEREON IS THE PROPERTY OF:</p> <p>THIS DRAWING AND INFORMATION THEREON IS CONFIDENTIAL. MUST NOT MADE PUBLIC, COPIED OR USED TO DISADVANTAGE OF SAID HAFELE AMERICA CO. IT IS SUBJECT TO RETURN ON DEMAND. 2006 HAFELE AMERICA, CO.</p>	<p>DATE: 10.14.2011</p> <p>SCALE:</p> <p>DRAWN BY: NPG</p> <p>PUM APPROVAL: DT</p>	<p>SPECIFICATION:</p> <p>MAT'L: See notes</p> <p>FINISH: See notes</p> <p>CUSTOMER APPROVAL:</p>

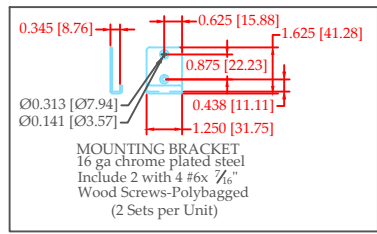
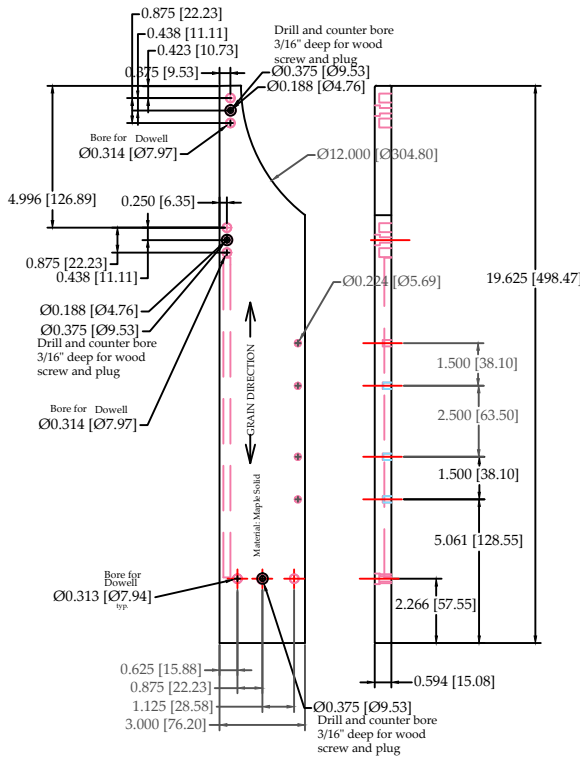

Side Panels
 (1 each per Unit)
 Left Side Shown
 Right Side is Mirror Image

Material: Birch plywood and Birch/maple solids
 Finish: 3 coat clear top coat finish
 Polished chrome rails and door mounting hardware
 Edgeworked sled assembly
 King 2MS2 Soft Close slides

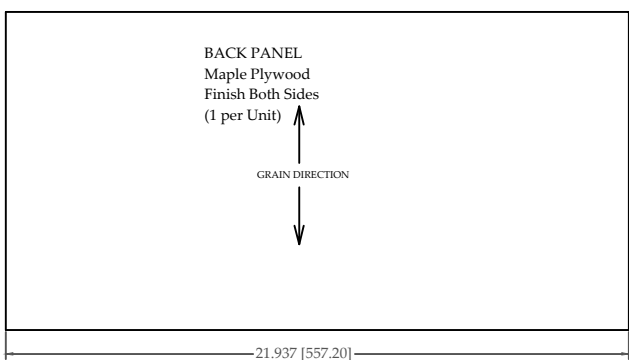
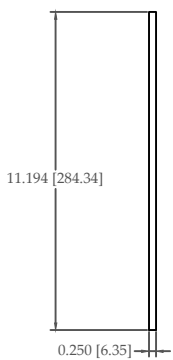
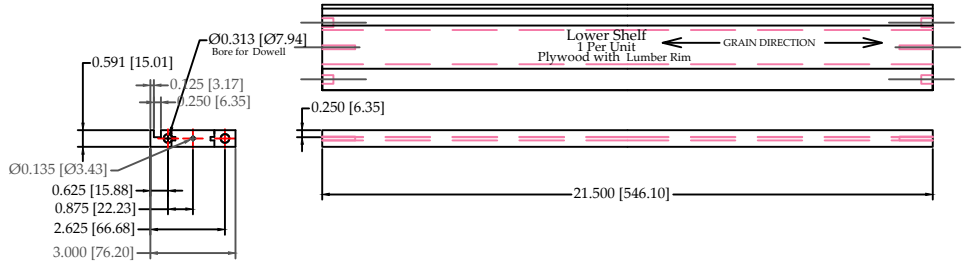
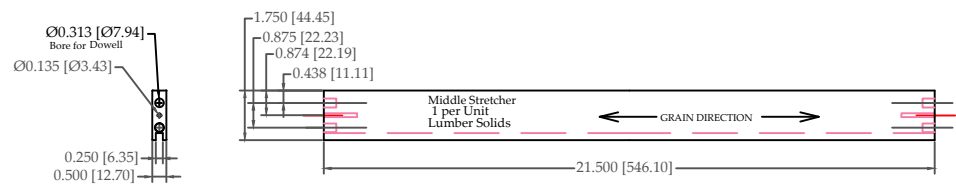
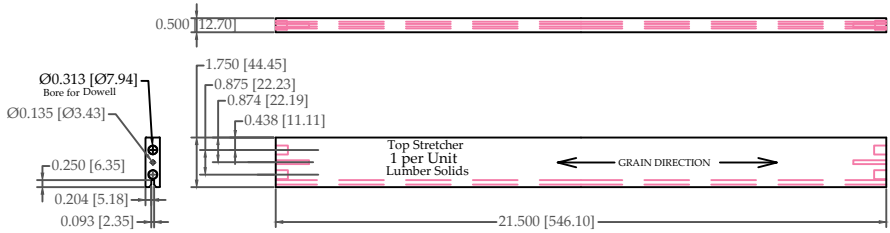
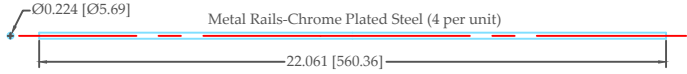

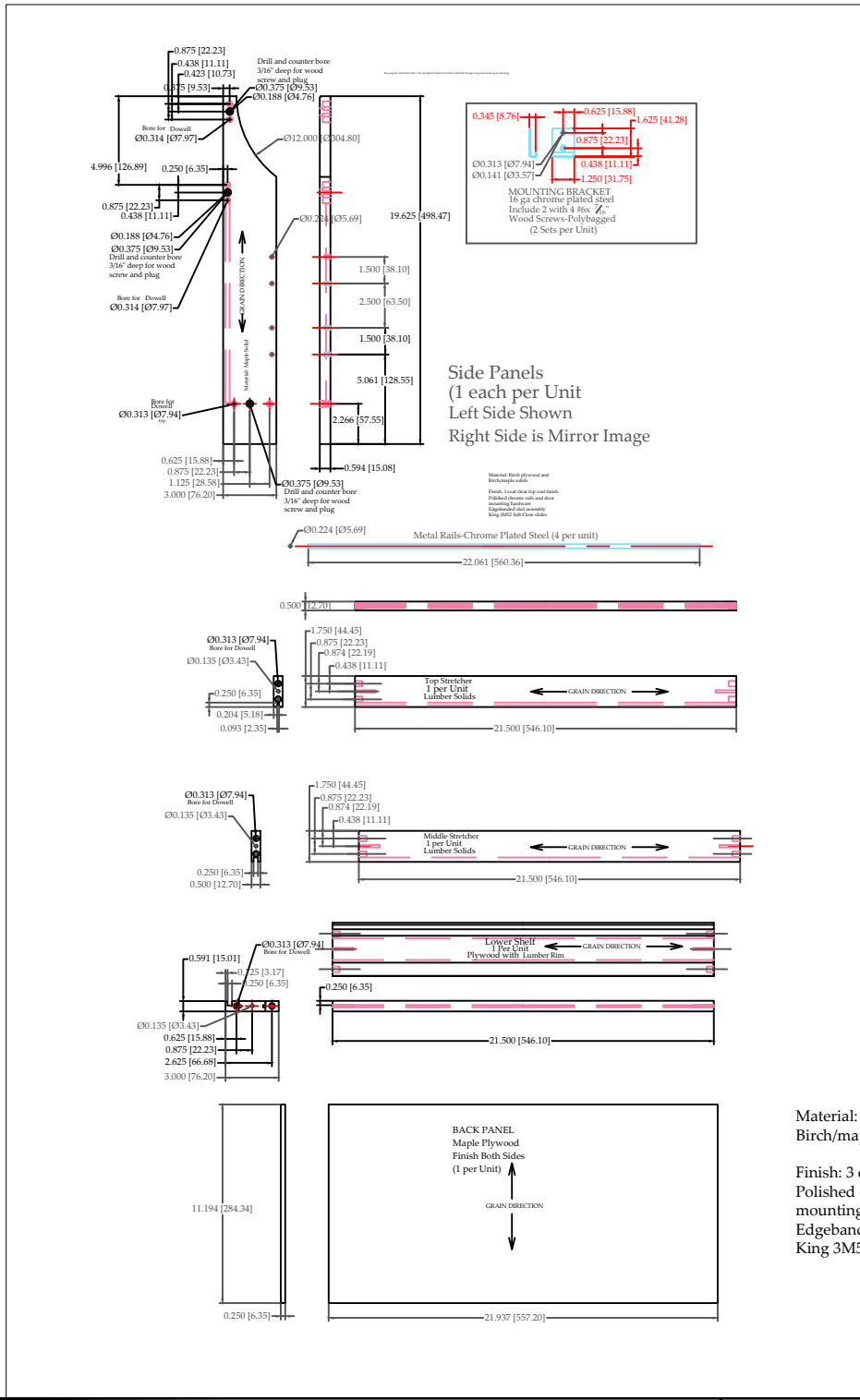

STATUS
05

11in Pullout Unit-Side Caddy Flat Storage Components.REV.001

546.32.810

NOTICE
THIS DRAWING AND ALL INFORMATION THEREON IS THE PROPERTY OF:



THIS DRAWING AND INFORMATION THEREON IS CONFIDENTIAL. MUST NOT MADE PUBLIC, COPIED OR USED TO DISADVANTAGE OF SAID HAFELE AMERICA CO. IT IS SUBJECT TO RETURN ON DEMAND.

2006 HAFELE AMERICA, CO.

DATE: 10.14.2011

SCALE:

DRAWN BY: NPG

PUM APPROVAL DT

SPECIFICATION

MAT'L: See notes

FINISH: See notes

CUSTOMER APPROVAL

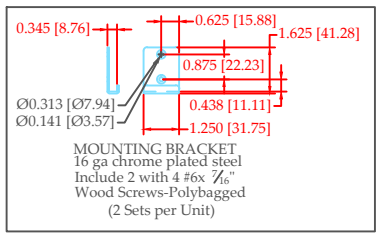
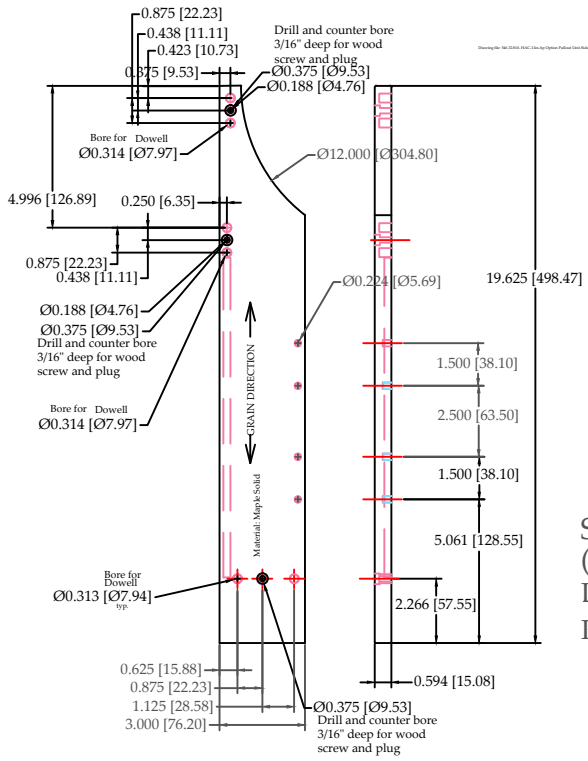

Side Panels
(1 each per Unit
Left Side Shown
Right Side is Mirror Image

Material: Birch plywood and
Birch/maple solids

Finish: 3 coat clear top coat finish
Polished chrome rails and door
mounting hardware
Edgeworked-slat assembly
King 2MS2 Soft Close slides

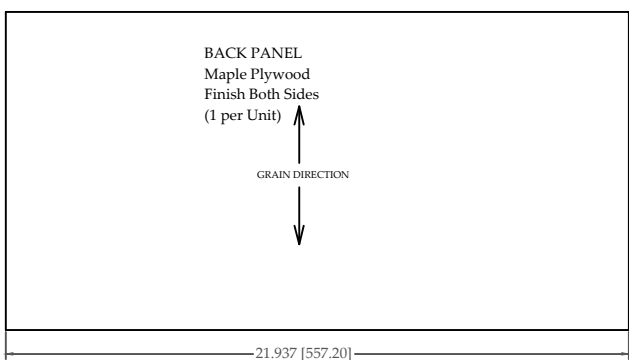
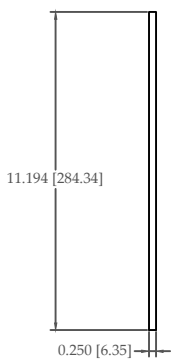
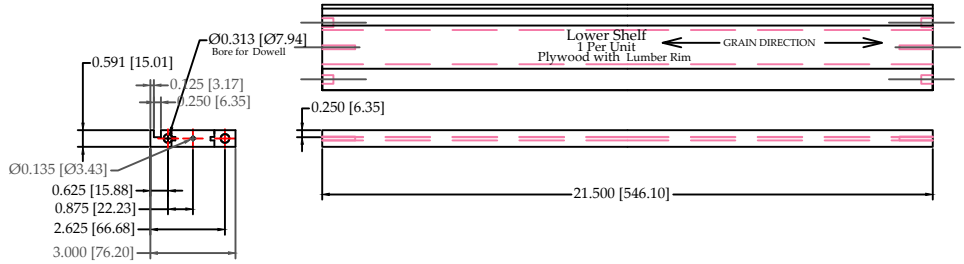
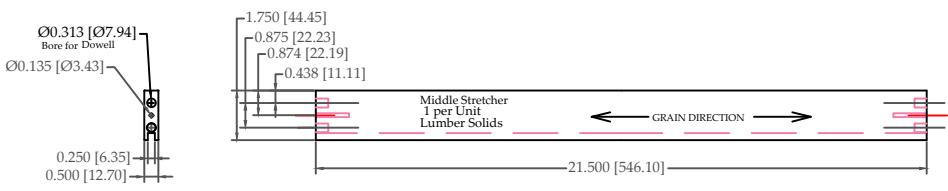
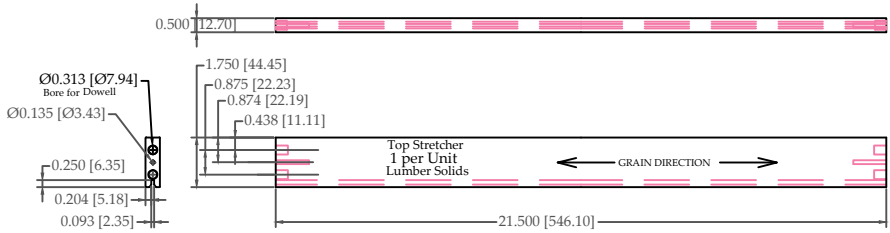
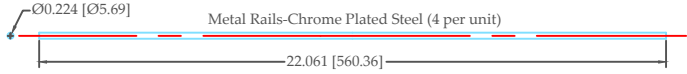

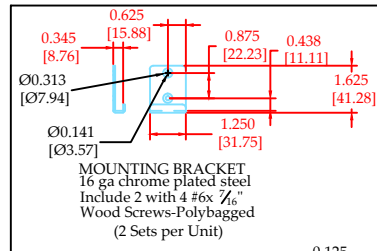

SIDE CADDY Ap-Flat Storage Ap-11" Unit

Materials and finish to be Spec'd Separately

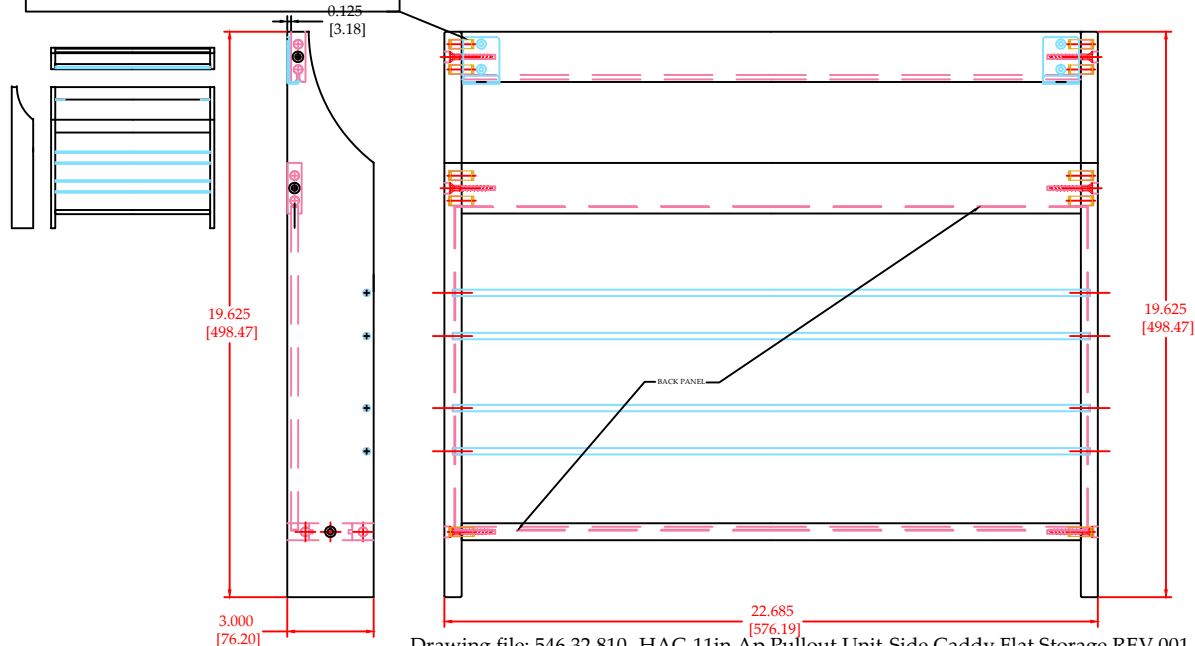

Drawing file: 546.32.810- HAC-11in.Ap Pullout Unit-Side Caddy Flat Storage.REV.001.dwg
Material: Birch plywood and Birch/maple solids

Finish: 3 coat clear top coat finish
Polished chrome rails and door mounting hardware
Edgembanded sled assembly
King 3M52 Soft Close slides

STATUS
05

SIDE CADDY Ap-Flat Storage Ap-11in Unit	546.32.810
---	------------

DATE: 10.14.2011	SPECIFICATION
SCALE:	MAT'L: See notes
DRAWN BY: NPG	FINISH: See notes
PUM APPROVAL: DT	CUSTOMER APPROVAL

NOTICE
THIS DRAWING AND ALL INFORMATION THEREON IS THE PROPERTY OF:

THIS DRAWING AND INFORMATION THEREON IS CONFIDENTIAL. MUST NOT BE MADE PUBLIC, COPIED OR USED TO DISADVANTAGE OF SAID HAFELE AMERICA CO. IT IS SUBJECT TO RETURN ON DEMAND.
2008 HAFELE AMERICA, CO.

RevNo	Project # or change Request #	Date	Signature	Checked
001	File updated	12.01.2011	NPG	RM

SIDE CADDY Ap-Flat Storage Ap-11" Unit

Materials and finish to be Spec'd Separately

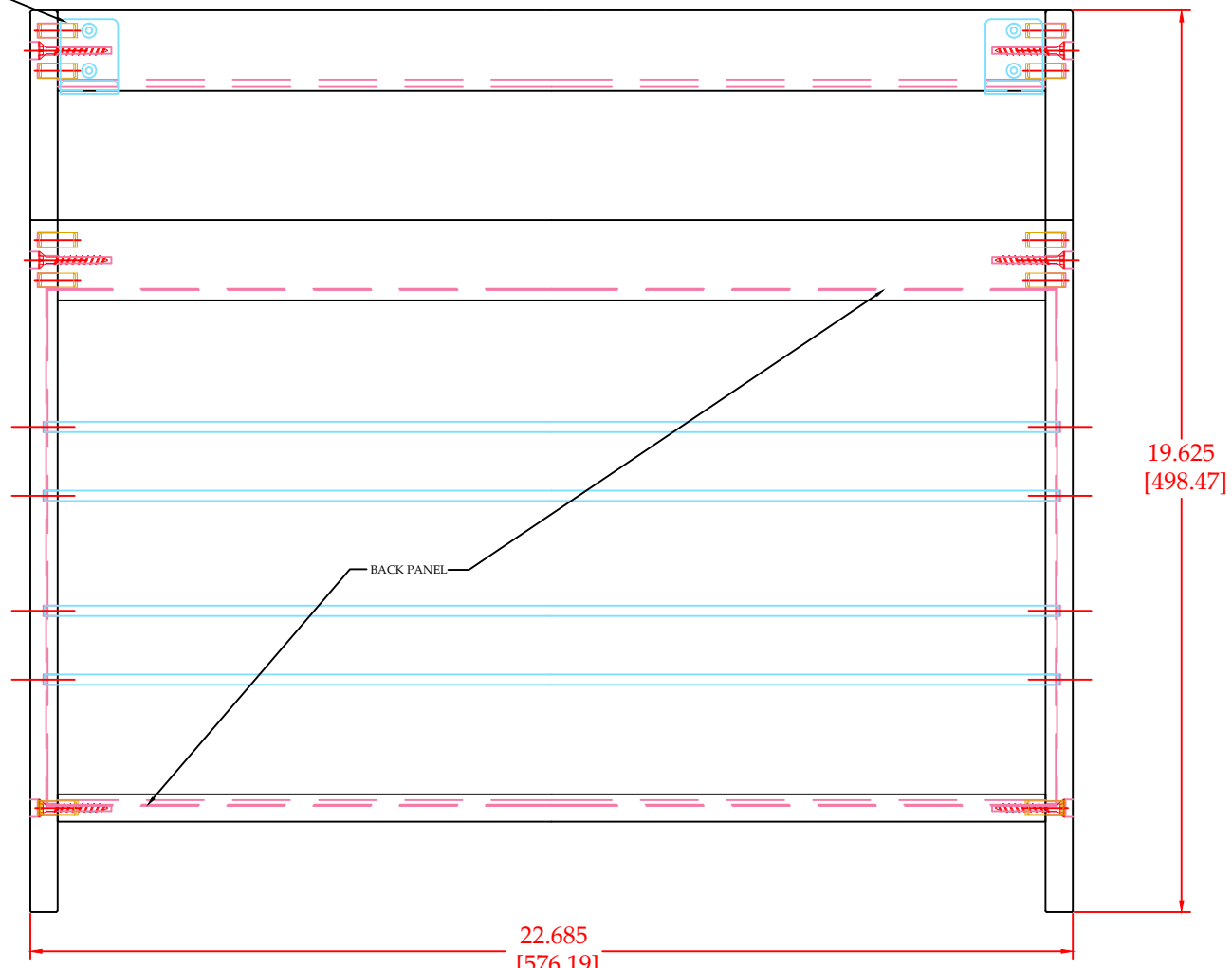
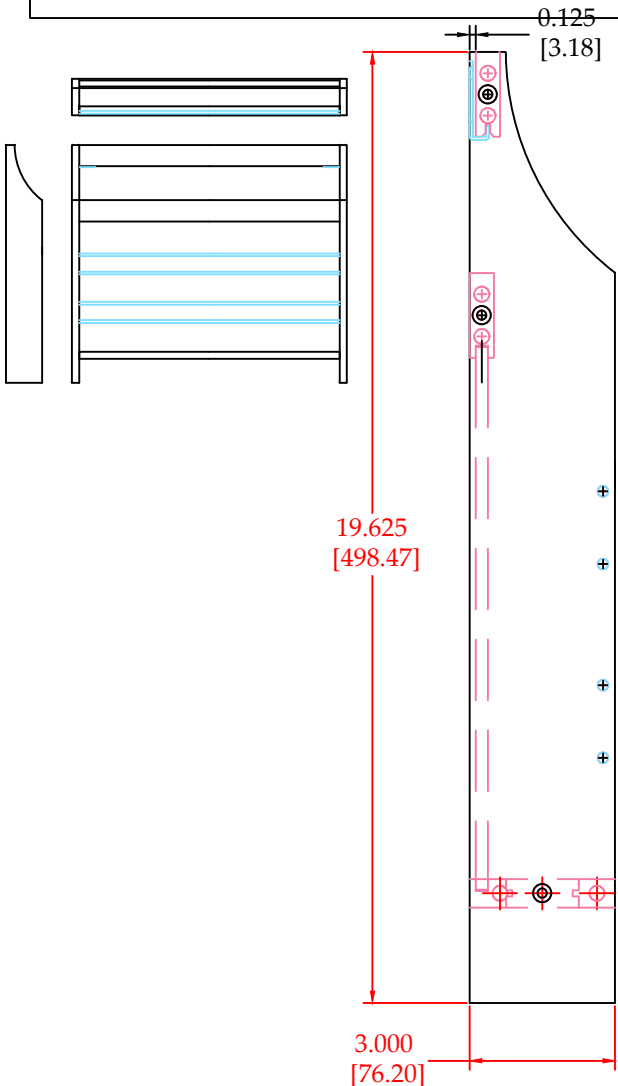
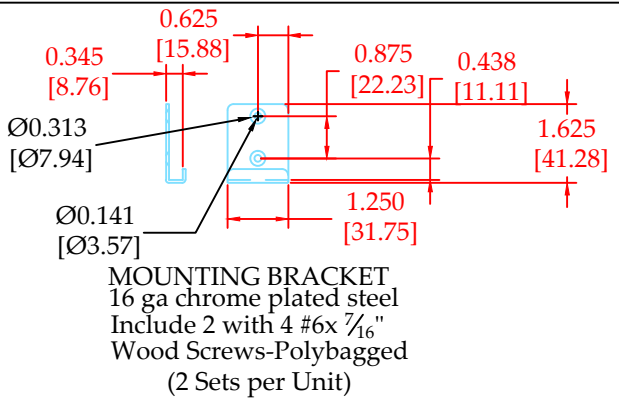

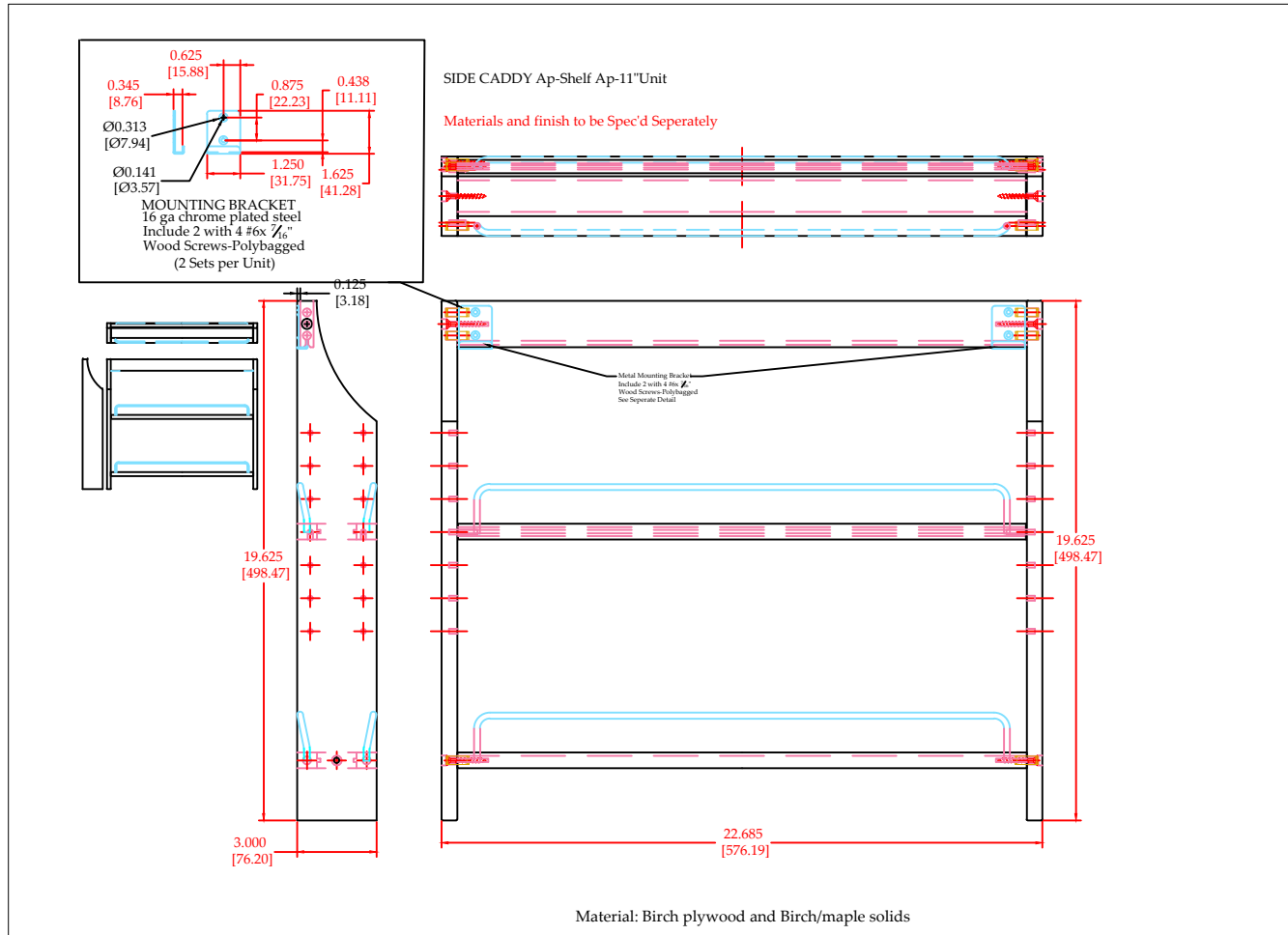

Material: Birch plywood and Birch/maple solids

Finish: 3 coat clear top coat finish
 Polished chrome rails and door mounting hardware
 Edgebanded sled assembly
 King 3M52 Soft Close slides

STATUS

05

11" Pull Out Side Caddy Shelf 546.32.830

Rev/No	Project # or change Request #	Date	Signature	Checked
001	File updated	12.01.2011	NPG	RM

NOTICE
 THIS DRAWING AND ALL INFORMATION THEREON IS THE PROPERTY OF:



THIS DRAWING AND INFORMATION THEREON IS CONFIDENTIAL. MUST NOT BE MADE PUBLIC, COPIED OR USED TO DISADVANTAGE OF SAID HAFELE AMERICA CO. IT IS SUBJECT TO RETURN ON DEMAND.
 2008 HAFELE AMERICA, CO.

DATE:	10.14.2011	SPECIFICATION
SCALE:		MAT'L: See notes
DRAWN BY:	NPG	FINISH: See notes
PUM APPROVAL DT		CUSTOMER APPROVAL

SIDE CADDY Ap-Shelf Ap-11"Unit

Materials and finish to be Spec'd Separately

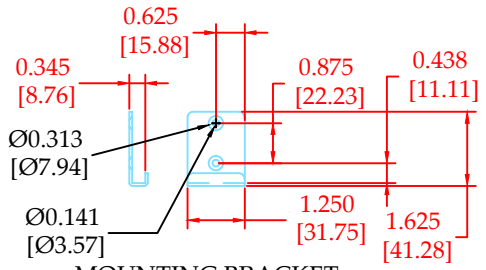
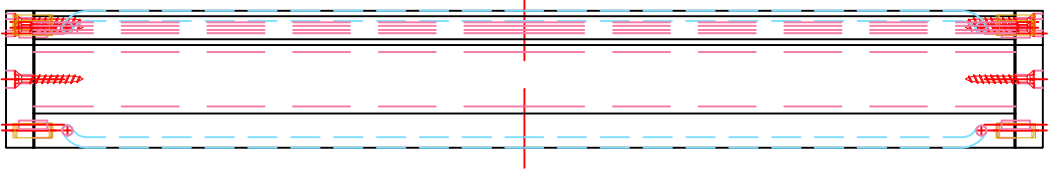

MOUNTING BRACKET
 16 ga chrome plated steel
 Include 2 with 4 #6x 7/16"
 Wood Screws-Polybagged
 (2 Sets per Unit)

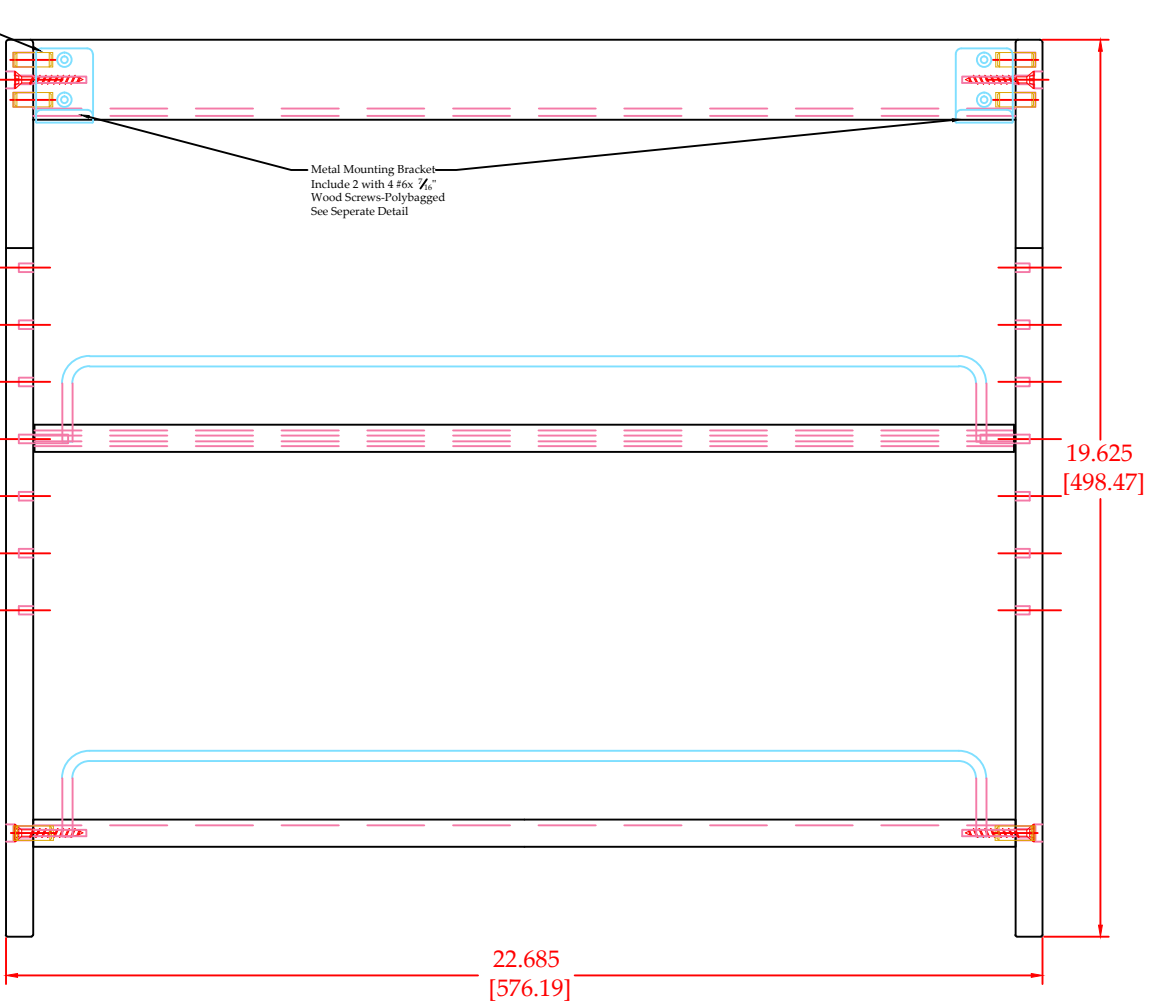
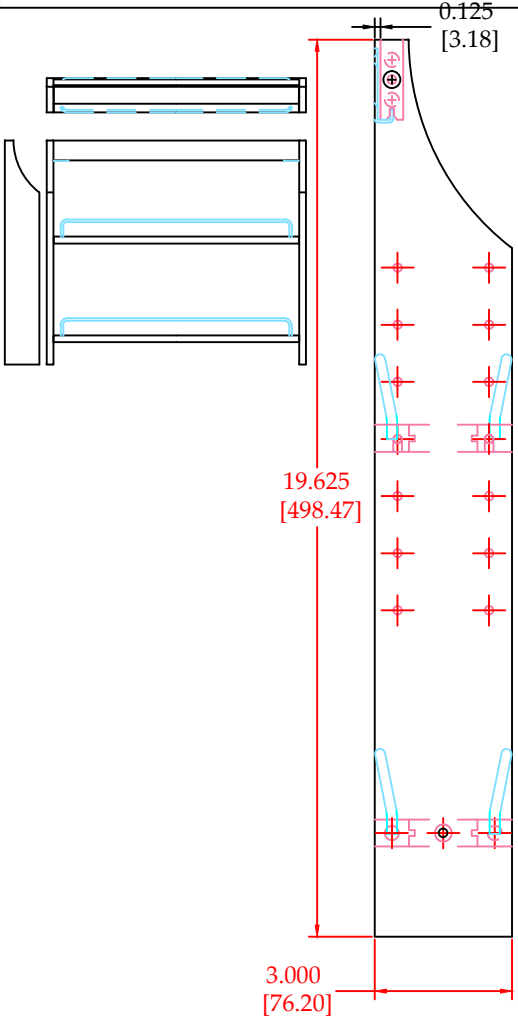

Stainless Panel App-11" Unit
(for Use With Vertical Divider Ap)

Materials and finish to be Spec'd Separately

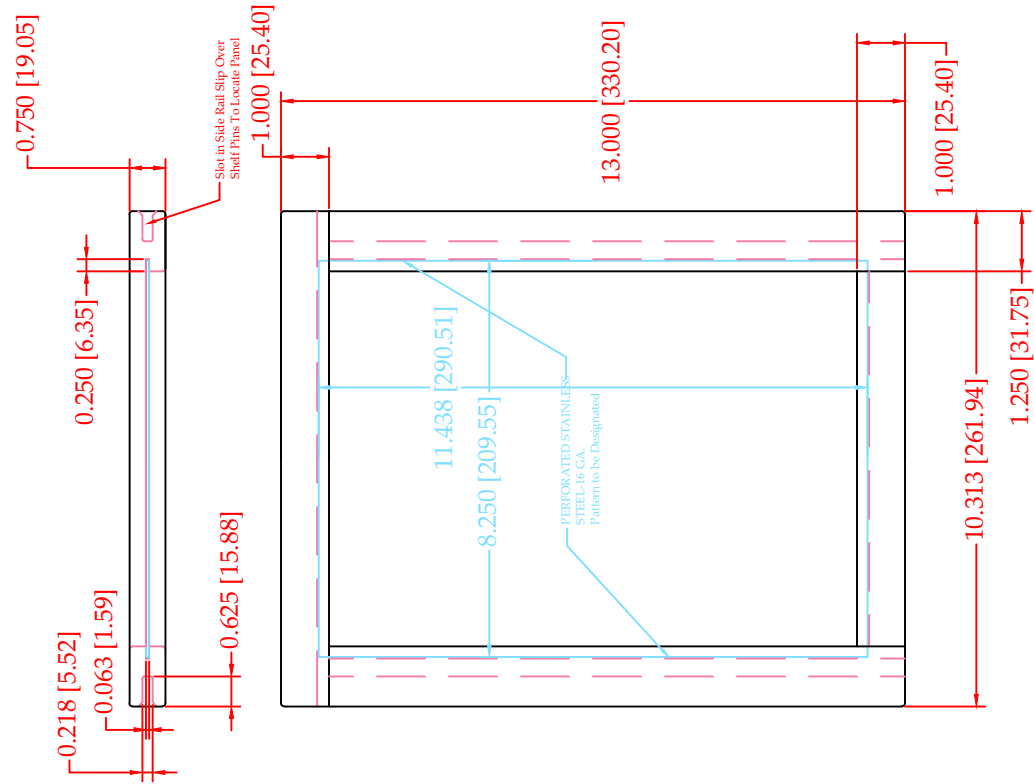

Material: Birch plywood and Birch/maple solids

Finish: 3 coat clear top coat finish
 Polished chrome rails and door mounting hardware
 Edgembanded sled assembly
 King 3M52 Soft Close slides

STATUS
05
11" Pull Out Stainless Panel
546.32.840

RevNo	Project # or change Request #	Date	Signature	Checked
001	File updated	12.01.2011	NPG	RM

NOTICE
 THIS DRAWING AND ALL INFORMATION THEREON IS THE PROPERTY OF:

HÄFELE

THIS DRAWING AND INFORMATION THEREON IS CONFIDENTIAL. MUST NOT MADE PUBLIC, COPIED OR USED TO DISADVANTAGE OF SAID HÄFELE AMERICA CO. IT IS SUBJECT TO RETURN ON DEMAND.
 2008 HAFELE AMERICA, CO.

DATE:	10.14.2011	SPECIFICATION	
SCALE:		MAT'L:	See notes
DRAWN BY:	NPG	FINISH:	See notes
PUM APPROVAL	DT	CUSTOMER APPROVAL	